

WRIGHT COUNTY SURVEYORS OFFICE

Public Works Building
Buffalo, Minn. 55313

SECTION 21 TOWNSHIP 122 RANGE 27

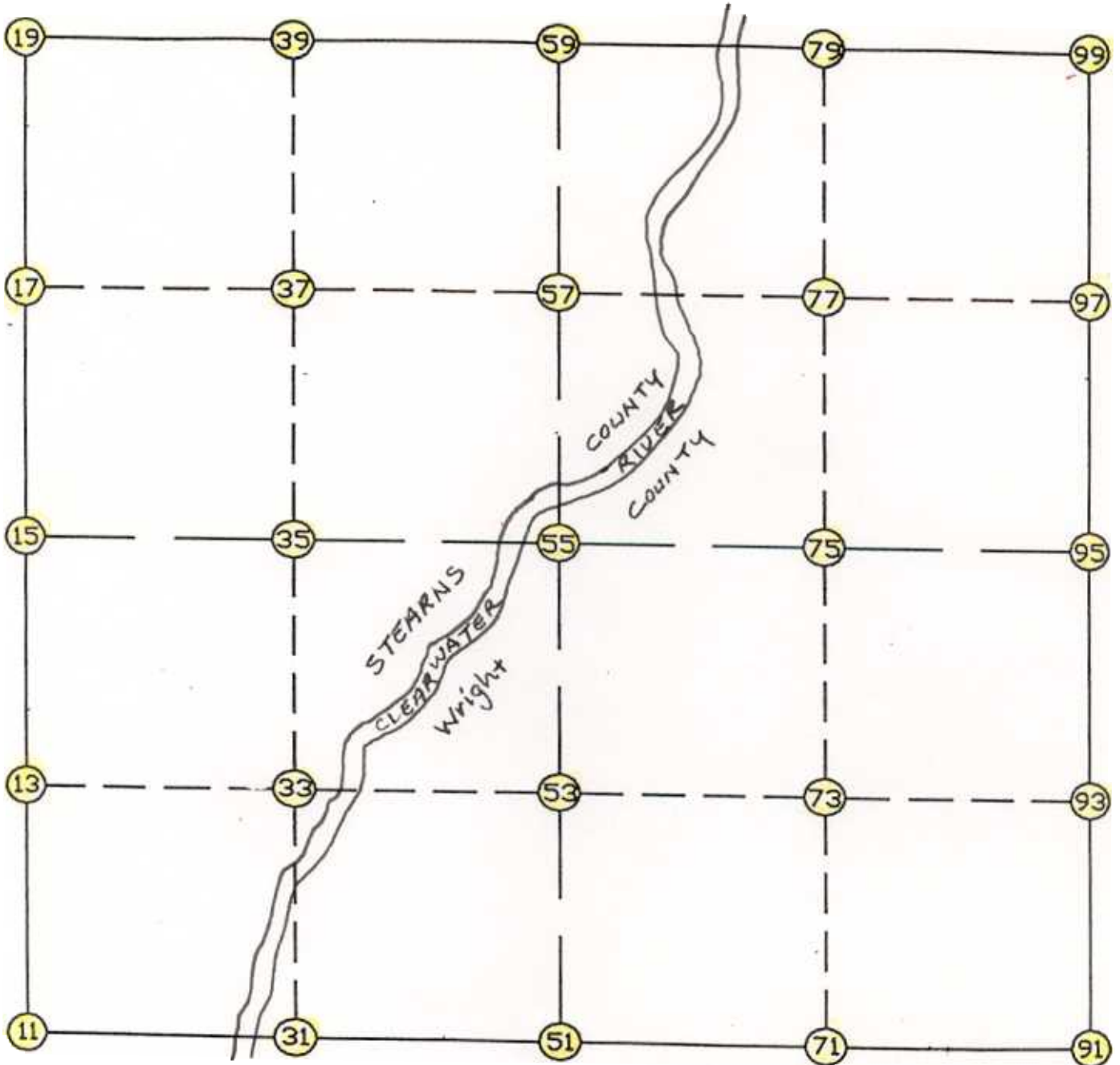

REMARKS

THE INFORMATION SHOWN HEREON IS A COMPILATION OF WRIGHT COUNTY RECORDS AND IS INTENDED TO BE USED FOR COMPARISON PURPOSES ONLY. THE COUNTY IS NOT RESPONSIBLE FOR ANY INACCURACIES HEREIN CONTAINED.

Job # : 95-112
 Description: COUNTY COORDINATES SECTION 21 T122 R27
 # of chars. in point descr.: 10

 FROM TYPE BEARING DISTANCE TO NORTHING EASTING

LIST POINTS

POINT	NORTHING	EASTING	ELEVATION	DESCR
11	237632.231704	444957.377917		
13	238960.607385	444999.613424		
15	240288.983065	445041.848931		
17	241618.512010	445046.350183		
19	242948.040956	445050.851434		
31	237646.207347	446287.618166		
33	238972.548860	446325.231811		
35	240298.890373	446362.845455		
37	241630.883047	446381.718391		
39	242962.875720	446400.591327		
51	237660.182990	447617.858416		
53	238984.490336	447650.850198		
55	240308.797681	447683.841980		
57	241643.254083	447717.086600		
59	242977.710485	447750.331220		
71	237665.486330	448944.773928		
73	238992.162512	448983.720004		
75	240318.838694	449022.666080		
77	241651.837704	449061.437434		
79	242984.836715	449100.208787		
91	237670.789670	450271.689440		
93	238999.834688	450316.589810		
95	240328.879706	450361.490180		
97	241660.421325	450405.788267		
99	242991.962944	450450.086355		

START				11	237632.232	444957.378
11	INV N	1-49-16.0 E	2658.094	15	240288.983	445041.849
15	INV N	0-11-38.3 E	2659.073	19	242948.041	445050.851
19	INV N	89-22-13.1 E	2699.643	59	242977.710	447750.331
59	INV N	89-41-51.1 E	2699.793	99	242991.963	450450.086
99	INV S	1-54-19.5 W	2664.557	95	240328.880	450361.490
95	INV S	1-56-05.8 W	2659.607	91	237670.790	450271.689
91	INV S	89-46-15.6 W	2653.852	51	237660.183	447617.858
51	INV S	89-23-53.0 W	2660.627	11	237632.232	444957.378

START				51	237660.183	447617.858
51	INV N	1-25-37.5 E	2649.436	55	240308.798	447683.842
55	INV N	1-25-37.5 E	2669.741	59	242977.710	447750.331
START				15	240288.983	445041.849
15	INV N	89-34-13.1 E	2642.067	55	240308.798	447683.842
55	INV N	89-34-13.1 E	2677.724	95	240328.880	450361.490

POINT-POINT ANGLES

ANGLE	51 -	11 -	15:	C.W.	272-25-22.9	C.C.W.	87-34-37.1	2658.094
ANGLE	11 -	15 -	19:	C.W.	178-22-22.4	C.C.W.	181-37-37.6	2659.073
ANGLE	15 -	19 -	59:	C.W.	269-10-34.7	C.C.W.	90-49-25.3	2699.643
ANGLE	19 -	59 -	99:	C.W.	180-19-38.0	C.C.W.	179-40-22.0	2699.793
ANGLE	59 -	99 -	95:	C.W.	272-12-28.4	C.C.W.	87-47-31.6	2664.557
ANGLE	99 -	95 -	91:	C.W.	180-01-46.2	C.C.W.	179-58-13.8	2659.607
ANGLE	95 -	91 -	51:	C.W.	267-50-09.8	C.C.W.	92-09-50.2	2653.852
ANGLE	91 -	51 -	11:	C.W.	179-37-37.4	C.C.W.	180-22-22.6	2660.627