

WRIGHT COUNTY SURVEYORS OFFICE

Public Works Building  
Buffalo, Minn. 55313

SECTION 16 TOWNSHIP 122 RANGE 27

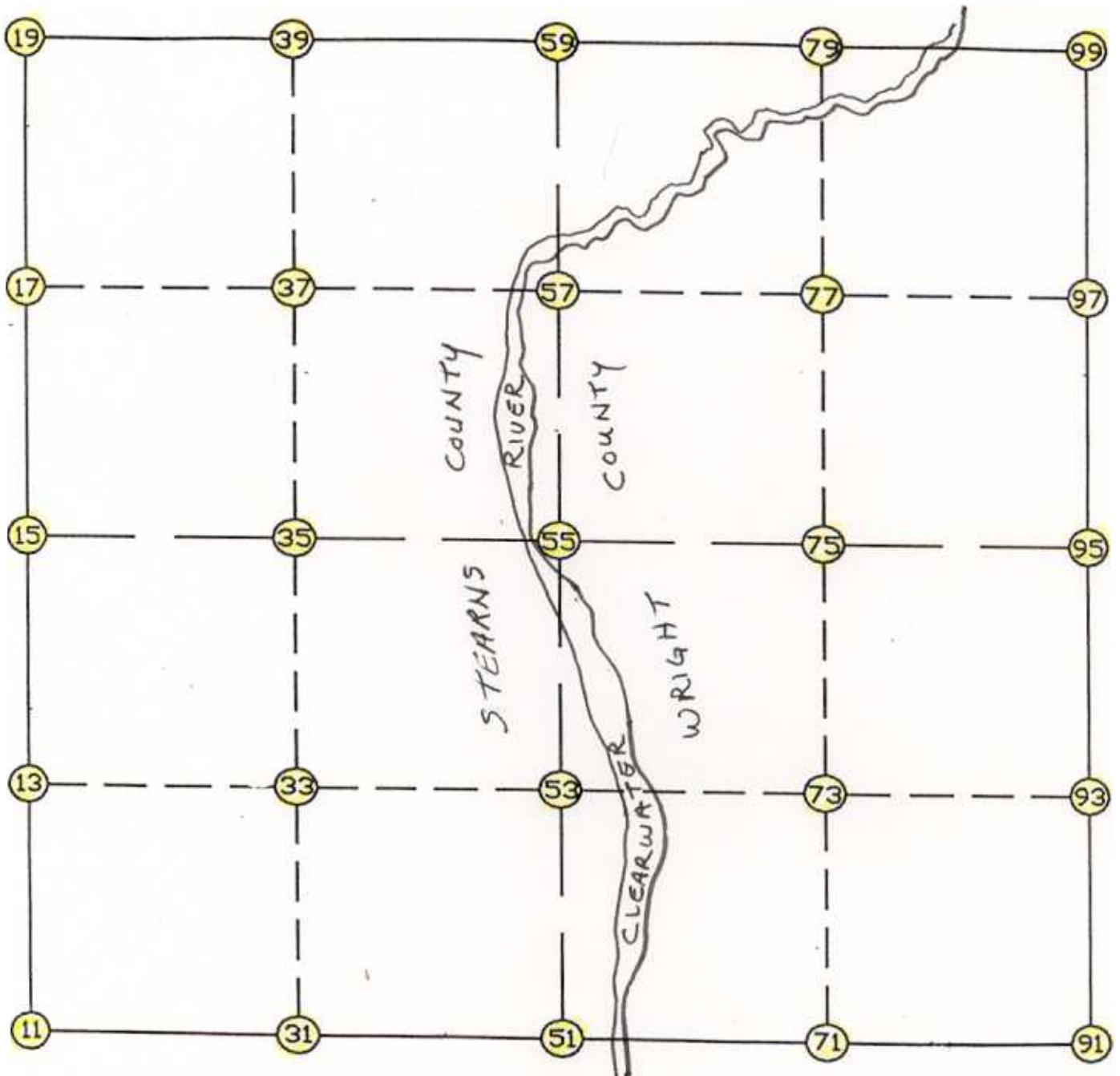

REMARKS

\_\_\_\_\_  
\_\_\_\_\_  
\_\_\_\_\_

THE INFORMATION SHOWN HEREON IS A COMPILATION OF WRIGHT COUNTY RECORDS AND IS INTENDED TO BE USED FOR COMPARISON PURPOSES ONLY. THE COUNTY IS NOT RESPONSIBLE FOR ANY INACCURACIES HEREIN CONTAINED.

JOB # : 95-112

Description: COUNTY COORDINATES SECTION 16 T122 R27

# of chars. in point descr.: 10

FROM TYPE	BEARING	DISTANCE	TO	NORTHING	EASTING
-----------	---------	----------	----	----------	---------

LIST POINTS

POINT	NORTHING	EASTING	ELEVATION	DESCR
11	242948.040956	445050.851434		
13	244276.511416	445068.210530		
15	245604.981876	445085.569625		
17	246933.306362	445103.002142		
19	248261.630848	445120.434659		
31	242962.875720	446400.591327		
33	244288.132161	446410.945835		
35	245613.388601	446421.300344		
37	246943.872206	446431.704992		
39	248274.355811	446442.109641		
51	242977.710485	447750.331220		
53	244299.752905	447753.681141		
55	245621.795326	447757.031062		
57	246954.438050	447760.407843		
59	248287.080773	447763.784624		
71	242984.836715	449100.208787		
73	244307.550252	449101.390071		
75	245630.263790	449102.571354		
77	246956.043613	449104.873481		
79	248281.823437	449107.175609		
91	242991.962944	450450.086355		
93	244315.347599	450449.099000		
95	245638.732254	450448.111646		
97	246957.649177	450449.339119		
99	248276.566100	450450.566593		

START			11	242948.041	445050.851	
11	INV N	0-44-55.1 E	2657.168	15	245604.982	445085.570
15	INV N	0-45-06.8 E	2656.878	19	248261.631	445120.435
19	INV N	89-26-54.2 E	2643.472	59	248287.081	447763.785
59	INV S	89-46-32.8 E	2686.803	99	248276.566	450450.567
99	INV S	0-03-12.0 W	2637.835	95	245638.732	450448.112
95	INV S	0-02-33.9 E	2646.770	91	242991.963	450450.086
91	INV S	89-41-51.1 W	2699.793	51	242977.710	447750.331
51	INV S	89-22-13.1 W	2699.643	11	242948.041	445050.851

START			51	242977.710	447750.331	
51	INV N	0-08-42.7 E	2644.093	55	245621.795	447757.031
55	INV N	0-08-42.7 E	2665.294	59	248287.081	447763.785

START			15	245604.982	445085.570	
15	INV N	89-38-21.8 E	2671.514	55	245621.795	447757.031
55	INV N	89-38-21.8 E	2691.134	95	245638.732	450448.112

POINT-POINT ANGLES

ANGLE	51 -	11 -	15:	C.W.	271-22-42.0	C.C.W.	88-37-18.0	2657.168
ANGLE	11 -	15 -	19:	C.W.	180-00-11.7	C.C.W.	179-59-48.3	2656.878
ANGLE	15 -	19 -	59:	C.W.	268-41-47.4	C.C.W.	91-18-12.6	2643.472
ANGLE	19 -	59 -	99:	C.W.	180-46-33.0	C.C.W.	179-13-27.0	2686.803
ANGLE	59 -	99 -	95:	C.W.	269-49-44.8	C.C.W.	90-10-15.2	2637.835
ANGLE	99 -	95 -	91:	C.W.	179-54-14.1	C.C.W.	180-05-45.9	2646.770
ANGLE	95 -	91 -	51:	C.W.	269-44-25.0	C.C.W.	90-15-35.0	2699.793
ANGLE	91 -	51 -	11:	C.W.	179-40-22.0	C.C.W.	180-19-38.0	2699.643