

WRIGHT COUNTY SURVEYORS OFFICE

Public Works Building  
Buffalo, Minn. 55313

SECTION 4 TOWNSHIP 21 RANGE 25

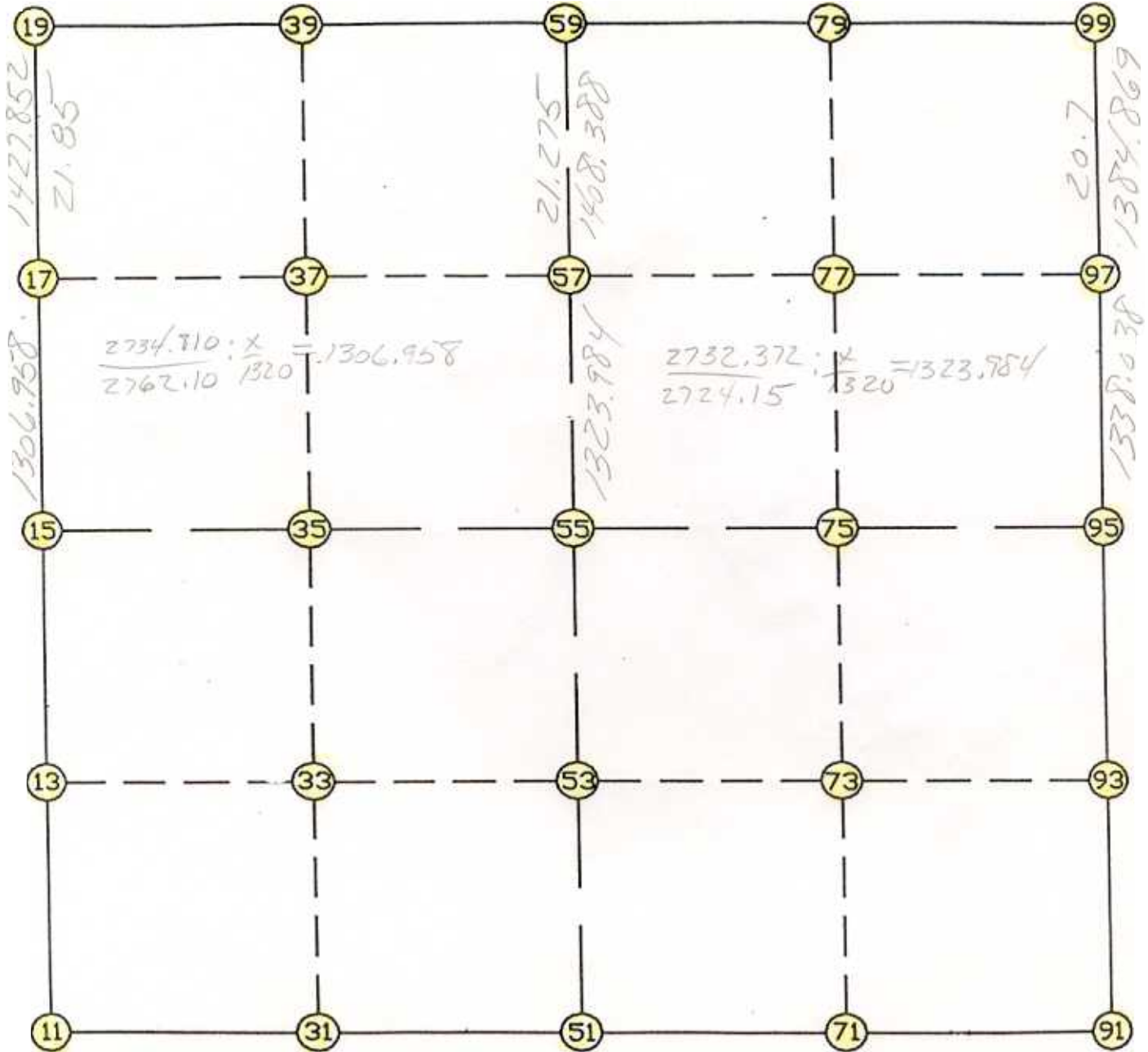

REMARKS

---



---



---

THE INFORMATION SHOWN HEREON IS A COMPILATION OF WRIGHT COUNTY RECORDS AND IS INTENDED TO BE USED FOR COMPARISON PURPOSES ONLY. THE COUNTY IS NOT RESPONSIBLE FOR ANY INACCURACIES HEREIN CONTAINED.

LOGO =

Wednesday September 6, 1995

3:30 PM

Coordinate File Name: SEC-04.CRD    Lowest pt #: 1    Highest pt #: 99  
 Job #: 95-75  
 Description: COUNTY COORDINATES SECTION 4 T121 R25  
 # of chars. in point descr.: 10

---

FROM TYPE	BEARING	DISTANCE	TO	NORTHING	EASTING
-----------	---------	----------	----	----------	---------

---

LIST POINTS

POINT	NORTHING	EASTING	ELEVATION	DESCR
11	221564.140925	509191.466093		
13	222864.409457	509058.310578		
15	224164.677990	508925.155063		
17	225466.059636	508804.552306		
19	226887.819296	508672.793773		
31	221519.266966	510514.662166		
33	222820.450082	510383.451325		
35	224121.633198	510252.240483		
37	225431.076984	510126.571092		
39	226842.706738	509991.094752		
51	221474.393007	511837.858239		
53	222776.490707	511708.592071		
55	224078.588406	511579.325903		
57	225396.095918	511448.529921		
59	226797.594180	511309.395730		
71	221416.461206	513158.397166		
73	222726.275189	513023.994383		
75	224036.089172	512889.591601		
77	225360.644941	512758.659678		
79	226750.498826	512621.273057		
91	221358.529405	514478.936093		
93	222676.059672	514339.396695		
95	223993.589938	514199.857298		
97	225325.193749	514068.797379		
99	226703.403471	513933.150384		

2

START					11	221564.141	509191.466
11	INV N	5-50-49.4 W	2614.137		15	224164.678	508925.155
15	INV N	5-17-40.7 W	2734.810		19	226887.819	508672.794
19	INV S	88-02-24.3 E	2638.145		59	226797.594	511309.396
59	INV S	87-56-38.4 E	2625.445		99	226703.403	513933.150
99	INV S	5-37-15.9 E	2722.907		95	223993.590	514199.857
95	INV S	6-02-44.3 E	2649.798		91	221358.529	514478.936
91	INV N	87-29-17.0 W	2643.618		51	221474.393	511837.858
51	INV N	88-03-27.6 W	2647.914		11	221564.141	509191.466
START					51	221474.393	511837.858
51	INV N	5-40-10.1 W	2616.997		55	224078.588	511579.326
55	INV N	5-40-10.1 W	2732.372		59	226797.594	511309.396
START					15	224164.678	508925.155
15	INV S	88-08-32.0 E	2655.567		55	224078.588	511579.326
55	INV S	88-08-32.0 E	2621.910		95	223993.590	514199.857

POINT-POINT ANGLES

ANGLE	51 -	11 -	15:	C.W.	262-12-38.1	C.C.W.	97-47-21.9	2614.137
ANGLE	11 -	15 -	19:	C.W.	180-33-08.7	C.C.W.	179-26-51.3	2734.810
ANGLE	15 -	19 -	59:	C.W.	277-15-16.4	C.C.W.	82-44-43.6	2638.145
ANGLE	19 -	59 -	99:	C.W.	180-05-45.9	C.C.W.	179-54-14.1	2625.445
ANGLE	59 -	99 -	95:	C.W.	262-19-22.5	C.C.W.	97-40-37.5	2722.907
ANGLE	99 -	95 -	91:	C.W.	179-34-31.6	C.C.W.	180-25-28.4	2649.798
ANGLE	95 -	91 -	51:	C.W.	278-33-27.3	C.C.W.	81-26-32.7	2643.618
ANGLE	91 -	51 -	11:	C.W.	179-25-49.4	C.C.W.	180-34-10.6	2647.914

START					51	221474.393	511837.858
	INV N	5-40-10 W	2616.997		55	224078.588	511579.326
55	INV N	5-40-10.1 W	2732.372		59	226797.594	511309.396
START					15	224164.678	508925.155
15	INV S	88-08-32.0 E	2655.567		55	224078.588	511579.326
55	INV S	88-08-32.0 E	2621.910		95	223993.590	514199.857

POINT-POINT ANGLES

ANGLE	51 -	11 -	15:	C.W.	262-12-38.1	C.C.W.	97-47-21.9	2614.137
ANGLE	11 -	15 -	19:	C.W.	180-33-08.7	C.C.W.	179-26-51.3	2734.810
ANGLE	15 -	19 -	59:	C.W.	277-15-16.4	C.C.W.	82-44-43.6	2638.145
ANGLE	19 -	59 -	99:	C.W.	180-05-45.9	C.C.W.	179-54-14.1	2625.445
ANGLE	59 -	99 -	95:	C.W.	262-19-22.5	C.C.W.	97-40-37.5	2722.907
ANGLE	99 -	95 -	91:	C.W.	179-34-31.6	C.C.W.	180-25-28.4	2649.798
ANGLE	95 -	91 -	51:	C.W.	278-33-27.3	C.C.W.	81-26-32.7	2643.618
ANGLE	91 -	51 -	11:	C.W.	179-25-49.4	C.C.W.	180-34-10.6	2647.914

Coordinates stored

Wednesday September 6, 1995

3:32 PM