

WRIGHT COUNTY SURVEYORS OFFICE

Public Works Building
Buffalo, Minn. 55313

SECTION 29 TOWNSHIP 121 RANGE 24

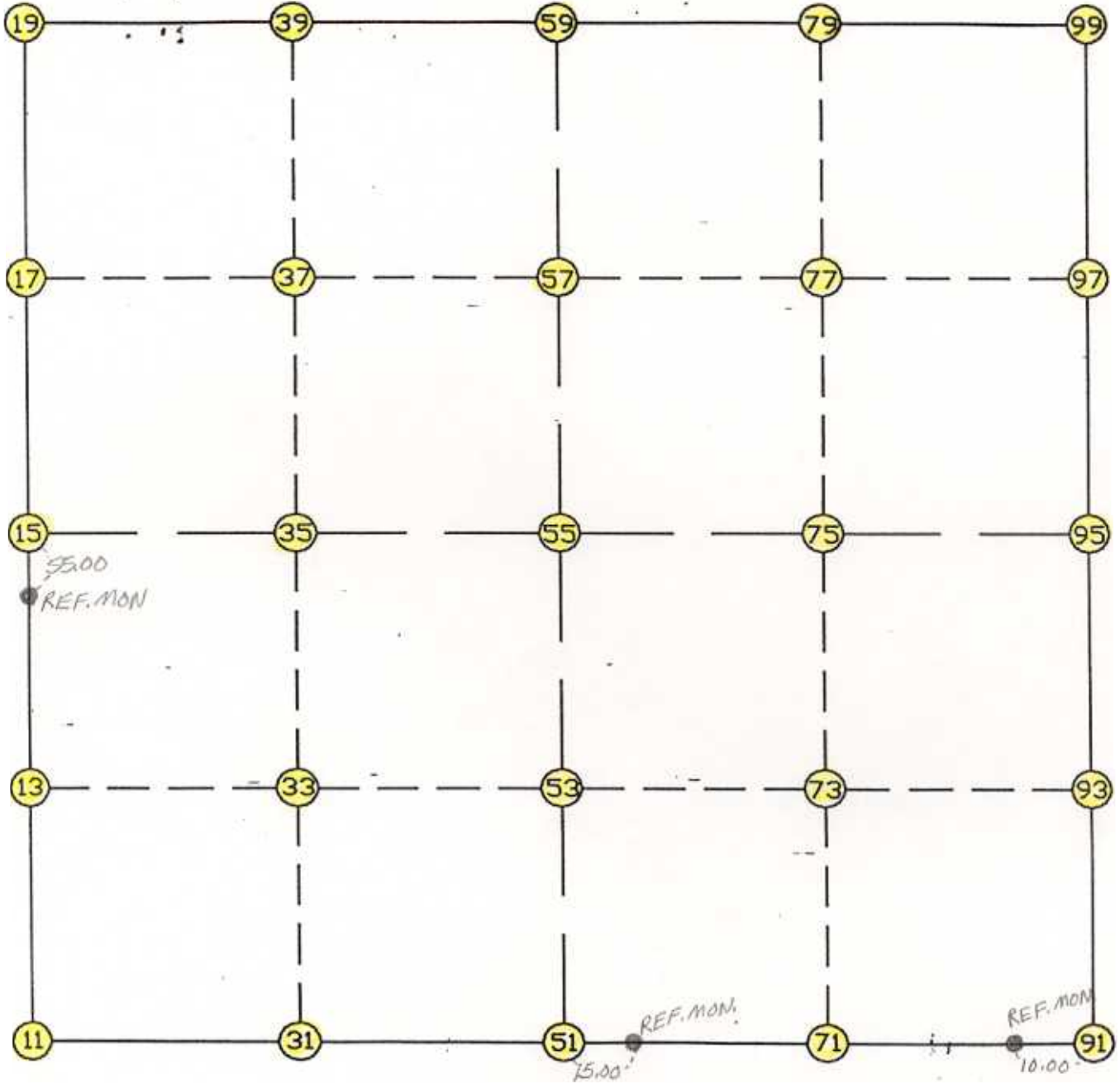

REMARKS

THE INFORMATION SHOWN HEREON IS A COMPILATION OF WRIGHT COUNTY RECORDS AND IS INTENDED TO BE USED FOR COMPARISON PURPOSES ONLY. THE COUNTY IS NOT RESPONSIBLE FOR ANY INACCURACIES HEREIN CONTAINED.

Coordinate File Name: SEC-29.CRD Lowest pt #: 1 Highest pt #: 99
 Job # : 95-09
 Description: COUNTY COORDINATES SECTION 29 T121 R24
 # of chars. in point descr.: 10

FROM TYPE	BEARING	DISTANCE	TO	NORTHING	EASTING
LIST POINTS					
POINT	NORTHING	EASTING	ELEVATION	DESCR	
11	200330.089490	535498.745840			
13	201635.236935	535479.292617			
15	202940.384380	535459.839393			
17	204261.110508	535461.671729			
19	205581.836636	535463.504064			
31	200313.806270	536813.120421			
33	201624.535445	536801.197375			
35	202935.264621	536789.274329			
37	204248.490898	536788.011723			
39	205561.717175	536786.749118			
51	200297.523050	538127.495002			
53	201613.833956	538123.102133			
55	202930.144861	538118.709264			
57	204235.871288	538114.351718			
59	205541.597714	538109.994172			
71	200281.959937	539447.658677			
73	201603.509039	539443.611752			
75	202925.058142	539439.564827			
77	204222.357392	539437.147591			
79	205519.656642	539434.730355			
91	200266.396823	540767.822351			
93	201593.184123	540764.121370			
95	202919.971422	540760.420390			
97	204208.843496	540759.943464			
99	205497.715570	540759.466537			

START				11	200330.089	535498.746
11	INV N	0-51-14.1 W	2610.585	15	202940.384	535459.839
15	INV N	0-04-46.2 E	2641.455	19	205581.837	535463.504
19	INV S	89-07-44.1 E	2646.796	59	205541.598	538109.994
59	INV S	89-03-04.0 E	2649.836	99	205497.716	540759.467
99	INV S	0-01-16.3 E	2577.744	95	202919.971	540760.420
95	INV S	0-09-35.4 E	2653.585	91	200266.397	540767.822
91	INV N	89-19-28.5 W	2640.511	51	200297.523	538127.495
51	INV N	89-17-24.8 W	2628.951	11	200330.089	535498.746
START				51	200297.523	538127.495
51	INV N	0-11-28.4 W	2632.636	55	202930.145	538118.709
55	INV N	0-11-28.4 W	2611.467	59	205541.598	538109.994
START				15	202940.384	535459.839
15	INV S	89-46-45.7 E	2658.890	55	202930.145	538118.709
55	INV S	89-46-45.7 E	2641.731	95	202919.971	540760.420

POINT-POINT ANGLES

ANGLE	51 -	11 -	15:	C.W.	268-26-10.7	C.C.W.	91-33-49.3	2610.585
ANGLE	11 -	15 -	19:	C.W.	180-56-00.3	C.C.W.	179-03-59.7	2641.455
ANGLE	15 -	19 -	59:	C.W.	270-47-29.8	C.C.W.	89-12-30.2	2646.796
ANGLE	19 -	59 -	99:	C.W.	180-04-40.0	C.C.W.	179-55-20.0	2649.836
ANGLE	59 -	99 -	95:	C.W.	269-01-47.7	C.C.W.	90-58-12.3	2577.744
ANGLE	99 -	95 -	91:	C.W.	179-51-41.0	C.C.W.	180-08-19.0	2653.585
ANGLE	95 -	91 -	51:	C.W.	270-50-06.9	C.C.W.	89-09-53.1	2640.511
ANGLE	91 -	51 -	11:	C.W.	180-02-03.7	C.C.W.	179-57-56.3	2628.951