

WRIGHT COUNTY SURVEYORS OFFICE

Public Works Building
Buffalo, Minn. 55313

SECTION 19 TOWNSHIP 121 RANGE 24

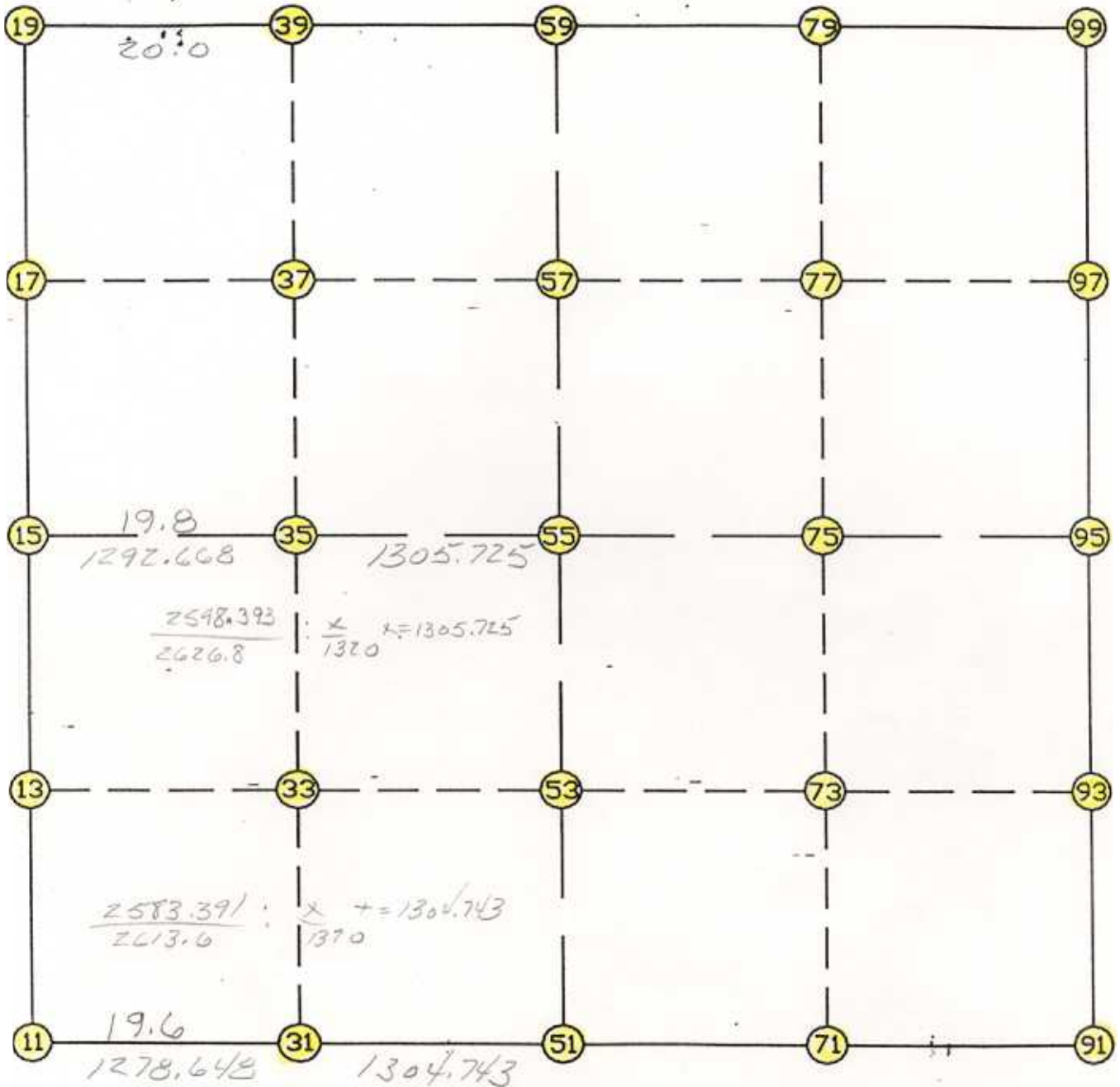

REMARKS

THE INFORMATION SHOWN HEREON IS A COMPILATION OF WRIGHT COUNTY RECORDS AND IS INTENDED TO BE USED FOR COMPARISON PURPOSES ONLY. THE COUNTY IS NOT RESPONSIBLE FOR ANY INACCURACIES HEREIN CONTAINED.

Coordinate File Name: SEC-19.CRD Lowest pt #: 1 Highest pt #: 99
 Job # : 95-09
 Description: COUNTY COORDINATES SECTION 19 T121 R24
 # of chars. in point descr.: 10

 FROM TYPE BEARING DISTANCE TO NORTHING EASTING

LIST POINTS						
POINT	NORTHING	EASTING	ELEVATION	DESCR		
11	205564.760358	530281.477656				
13	206893.557579	530283.234146				
15	208222.354801	530284.990636				
17	209542.157779	530286.315330				
19	210861.960758	530287.640025				
31	205572.765825	531560.100205				
33	206893.668071	531568.867713				
35	208214.529829	531577.634952				
37	209528.507432	531586.174712				
39	210842.456000	531594.714284				
51	205580.934671	532864.817632				
53	206893.780245	532874.076874				
55	208206.625818	532883.336115				
57	209514.788530	532892.562329				
59	210822.951241	532901.788543				
71	205581.385654	534164.160848				
73	206890.020840	534182.032347				
75	208198.656027	534199.903845				
77	209513.088834	534206.917119				
79	210827.521641	534213.930393				
91	205581.836636	535463.504064				
93	206886.261436	535489.987819				
95	208190.686236	535516.471574				
97	209511.389139	535521.271909				
99	210832.092041	535526.072243				

START				11	205564.760	530281.478
11	INV N	0-04-32.7 E	2657.597	15	208222.355	530284.991
15	INV N	0-03-27.0 E	2639.607	19	210861.961	530287.640
19	INV S	89-08-42.3 E	2614.440	59	210822.951	532901.789
59	INV N	89-48-01.5 E	2624.300	99	210832.092	535526.072
99	INV S	0-12-29.7 W	2641.423	95	208190.686	535516.472
95	INV S	1-09-47.2 W	2609.387	91	205581.837	535463.504
91	INV S	89-58-48.4 W	2598.687	51	205580.935	532864.818
51	INV S	89-38-28.6 W	2583.391	11	205564.760	530281.478
START				51	205580.935	532864.818
51	INV N	0-24-14.7 E	2625.756	55	208206.626	532883.336
55	INV N	0-24-14.7 E	2616.390	59	210822.951	532901.789
START				15	208222.355	530284.991
15	INV S	89-39-11.4 E	2598.393	55	208206.626	532883.336
55	INV S	89-39-11.4 E	2633.184	95	208190.686	535516.472

POINT-POINT ANGLES

ANGLE	51 -	11 -	15:	C.W.	270-26-04.1	C.C.W.	89-33-55.9	2657.597
ANGLE	11 -	15 -	19:	C.W.	179-58-54.4	C.C.W.	180-01-05.6	2639.607
ANGLE	15 -	19 -	59:	C.W.	270-47-50.7	C.C.W.	89-12-09.3	2614.440
ANGLE	19 -	59 -	99:	C.W.	178-56-43.8	C.C.W.	181-03-16.2	2624.300
ANGLE	59 -	99 -	95:	C.W.	270-24-28.2	C.C.W.	89-35-31.8	2641.423
ANGLE	99 -	95 -	91:	C.W.	180-57-17.5	C.C.W.	179-02-42.5	2609.387
ANGLE	95 -	91 -	51:	C.W.	268-49-01.2	C.C.W.	91-10-58.8	2598.687
ANGLE	91 -	51 -	11:	C.W.	179-39-40.2	C.C.W.	180-20-19.8	2583.391