

WRIGHT COUNTY SURVEYORS OFFICE

Public Works Building

Buffalo, Minn. 55313

SECTION 30 TOWNSHIP 121 RANGE 23

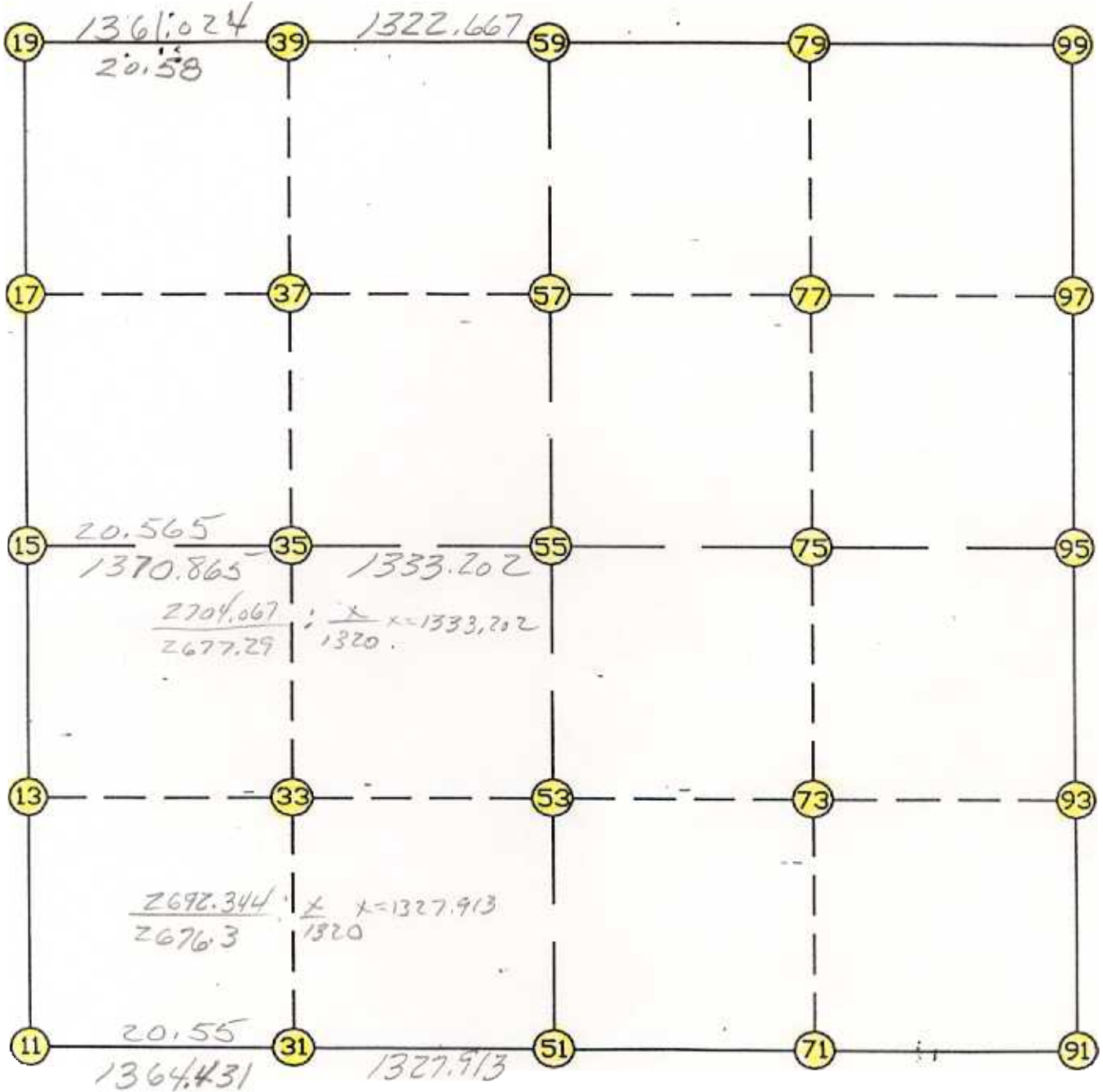

REMARKS

THE INFORMATION SHOWN HEREON IS A COMPILATION OF WRIGHT COUNTY RECORDS AND IS INTENDED TO BE USED FOR COMPARISON PURPOSES ONLY. THE COUNTY IS NOT RESPONSIBLE FOR ANY INACCURACIES HEREIN CONTAINED.

Description: COUNTY COORDINATES SECTION 30 T121 R23
 # of chars. in point descr.: 10

 FROM TYPE BEARING DISTANCE TO NORTHING EASTING

LIST POINTS

POINT	NORTHING	EASTING	ELEVATION	DESCR
11	200363.648881	561909.950717		
13	201686.094329	561888.550913		
15	203008.539778	561867.151108		
17	204329.860819	561861.975629		
19	205651.181860	561856.800150		
31	200352.749896	563274.338187		
33	201675.848763	563256.160370		
35	202998.947873	563237.982550		
37	204316.997037	563227.855513		
39	205635.045009	563217.728484		
51	200342.142616	564602.208723		
53	201665.881056	564586.680183		
55	202989.619496	564571.151642		
57	204304.491215	564555.727115		
59	205619.362934	564540.302588		
71	200342.170476	565937.875553		
73	201661.232072	565920.916042		
75	202980.293668	565903.956530		
77	204297.722435	565883.461512		
79	205615.151202	565862.966494		
91	200342.198336	567273.542383		
93	201656.583088	567255.151901		
95	202970.967840	567236.761418		
97	204290.953655	567211.195909		
99	205610.939470	567185.630400		

START				11	200363.649	561909.951
11	INV N	0-55-37.5 W	2645.237	15	203008.540	561867.151
15	INV N	0-13-27.9 W	2642.662	19	205651.182	561856.800
19	INV S	89-19-14.4 E	2683.691	59	205619.363	564540.303
59	INV S	89-49-03.2 E	2645.341	99	205610.939	567185.630
99	INV S	1-06-34.4 E	2640.467	95	202970.968	567236.761
95	INV S	0-48-05.8 E	2629.027	91	200342.198	567273.542
91	INV S	89-59-55.7 W	2671.334	51	200342.143	564602.209
51	INV N	89-32-32.4 W	2692.344	11	200363.649	561909.951
START				51	200342.143	564602.209
51	INV N	0-40-19.5 W	2647.659	55	202989.619	564571.152
55	INV N	0-40-19.5 W	2629.924	59	205619.363	564540.303
START				15	203008.540	561867.151
15	INV S	89-35-56.8 E	2704.067	55	202989.619	564571.152
55	INV S	89-35-56.8 E	2665.675	95	202970.968	567236.761

POINT-POINT ANGLES

ANGLE	51 -	11 -	15:	C.W.	268-36-54.9	C.C.W.	91-23-05.1	2645.237
ANGLE	11 -	15 -	19:	C.W.	180-42-09.6	C.C.W.	179-17-50.4	2642.662
ANGLE	15 -	19 -	59:	C.W.	270-54-13.5	C.C.W.	89-05-46.5	2683.691
ANGLE	19 -	59 -	99:	C.W.	179-30-11.2	C.C.W.	180-29-48.8	2645.341
ANGLE	59 -	99 -	95:	C.W.	268-42-28.8	C.C.W.	91-17-31.2	2640.467
ANGLE	99 -	95 -	91:	C.W.	180-18-28.6	C.C.W.	179-41-31.4	2629.027
ANGLE	95 -	91 -	51:	C.W.	270-48-01.5	C.C.W.	89-11-58.5	2671.334
ANGLE	91 -	51 -	11:	C.W.	180-27-31.9	C.C.W.	179-32-28.1	2692.344