

WRIGHT COUNTY SURVEYORS OFFICE

Public Works Building  
Buffalo, Minn. 55313

SECTION 19 TOWNSHIP 121 RANGE 23

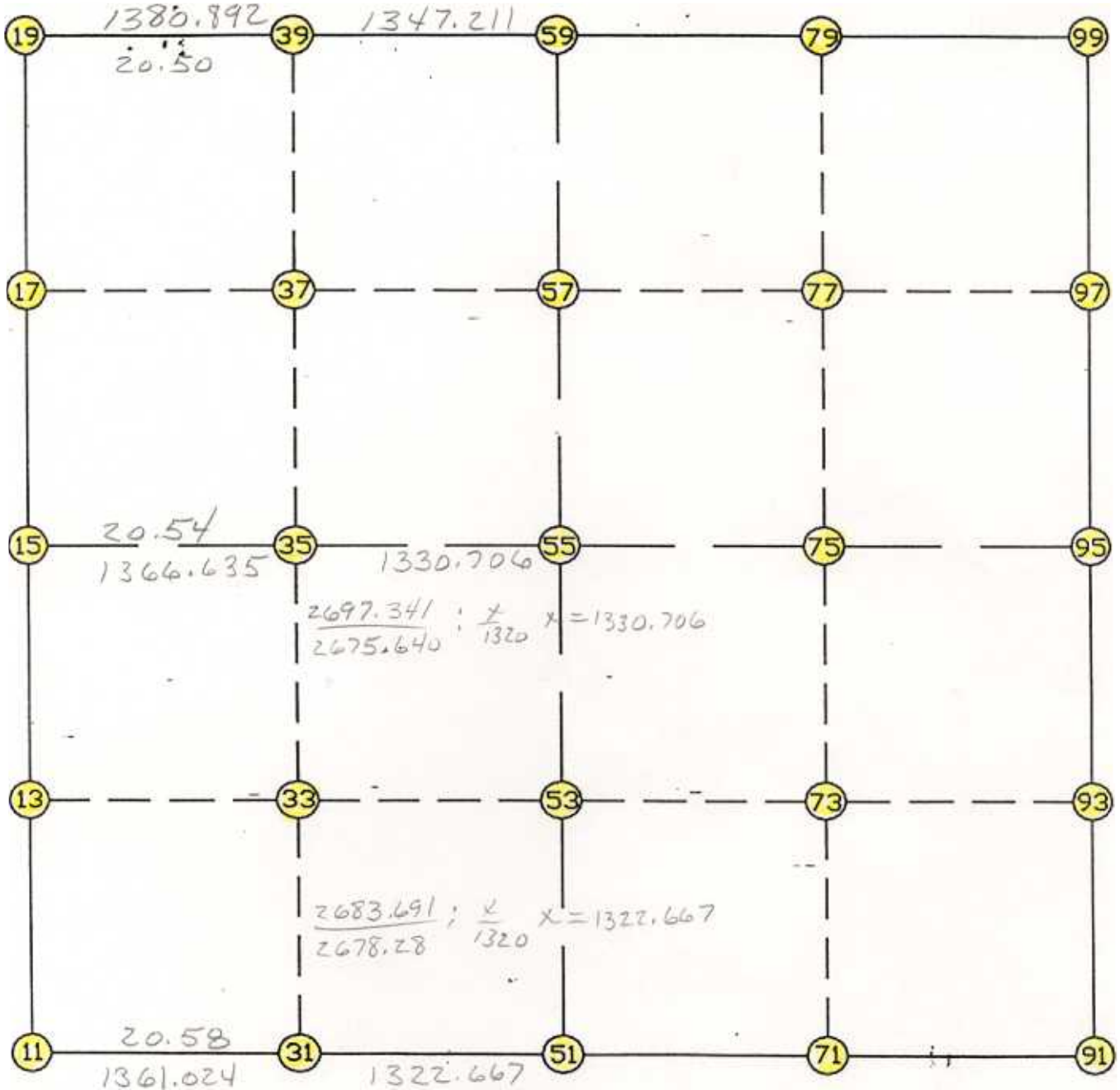

REMARKS

THE INFORMATION SHOWN HEREON IS A COMPILATION OF WRIGHT COUNTY RECORDS AND IS INTENDED TO BE USED FOR COMPARISON PURPOSES ONLY. THE COUNTY IS NOT RESPONSIBLE FOR ANY INACCURACIES HEREIN CONTAINED.

Job # : 95-08

Description: COUNTY COORDINATES SECTION 19 T121 R23

# of chars. in point descr.: 10

FROM TYPE	BEARING	DISTANCE	TO	NORTHING	EASTING
LIST POINTS					
POINT	NORTHING	EASTING	ELEVATION	DESCR	
11	205651.181860	561856.800150		E	
13	206973.422010	561852.093561			
15	208295.662160	561847.386972			
17	209618.514338	561834.139420			
19	210941.366517	561820.891869			
31	205635.045008	563217.728558			
33	206959.202938	563215.847411			
35	208283.359001	563213.966266			
37	209607.712241	563207.859630			
39	210932.063984	563201.753001			
51	205619.362934	564540.302588			
53	206945.371112	564542.460465			
55	208271.379291	564544.618341			
57	209597.183820	564546.775886			
59	210922.988350	564548.933431			
71	205615.151202	565862.966494			
73	206937.307788	565865.519948			
75	208259.464375	565868.073402			
77	209581.519134	565870.627682			
79	210903.573893	565873.181963			
91	205610.939470	567185.630400			
93	206929.244464	567188.579432			
95	208247.549458	567191.528463			
97	209565.854448	567194.479478			
99	210884.159437	567197.430494			

START	POINT	BEARING	DISTANCE	TO	NORTHING	EASTING
	11	INV N 0-12-14.2 W	2644.497	15	205651.182	561856.800
	15	INV N 0-34-25.5 W	2645.837	19	208295.662	561847.387
	19	INV S 89-36-50.5 E	2728.103	59	210941.367	561820.892
	59	INV S 89-09-36.2 E	2648.782	99	210922.988	564548.933
	99	INV S 0-07-41.7 W	2636.617	95	210884.159	567197.430
	95	INV S 0-07-41.4 W	2636.617	91	208247.549	567191.528
	91	INV N 89-49-03.2 W	2645.341	51	205610.939	567185.630
	51	INV N 89-19-14.4 W	2683.691	11	205619.363	564540.303

START	51	INV N 0-05-35.7 E	2652.020	55	205619.363	564540.303
	55	INV N 0-05-35.7 E	2651.613	59	208271.379	564544.618
START	15	INV S 89-29-03.1 E	2697.341	55	210922.988	564548.933
	55	INV S 89-29-03.1 E	2647.017	15	208295.662	561847.387
	15	INV S 89-29-03.1 E	2697.341	55	208271.379	564544.618
	55	INV S 89-29-03.1 E	2647.017	95	208247.549	567191.528

POINT-POINT ANGLES

ANGLE	51 - 11 - 15:	C.W. 269-07-00.2	C.C.W. 90-52-59.8	2644.497
ANGLE	11 - 15 - 19:	C.W. 179-37-48.7	C.C.W. 180-22-11.3	2645.837
ANGLE	15 - 19 - 59:	C.W. 270-57-35.1	C.C.W. 89-02-24.9	2728.103
ANGLE	19 - 59 - 99:	C.W. 180-27-14.2	C.C.W. 179-32-45.8	2648.782
ANGLE	59 - 99 - 95:	C.W. 269-17-17.9	C.C.W. 90-42-42.1	2636.617
ANGLE	99 - 95 - 91:	C.W. 179-59-59.7	C.C.W. 180-00-00.3	2636.617
ANGLE	95 - 91 - 51:	C.W. 270-03-15.4	C.C.W. 89-56-44.6	2645.341
ANGLE	91 - 51 - 11:	C.W. 180-29-48.8	C.C.W. 179-30-11.2	2683.691