

WRIGHT COUNTY SURVEYORS OFFICE

Public Works Building  
Buffalo, Minn. 55313

SECTION 26 TOWNSHIP 120 RANGE 26

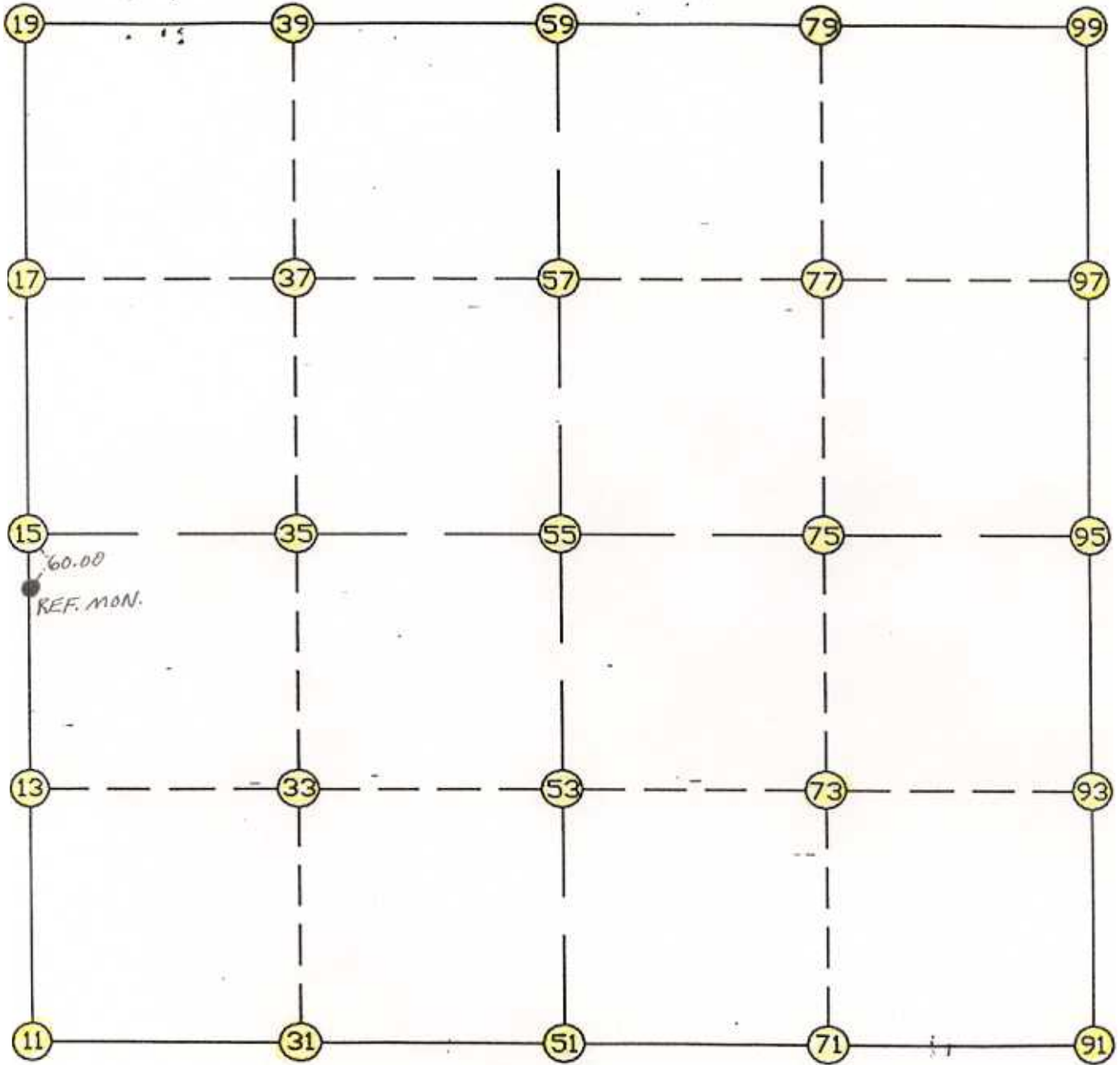

REMARKS

---

---

---

THE INFORMATION SHOWN HEREON IS A COMPILATION OF WRIGHT COUNTY RECORDS AND IS INTENDED TO BE USED FOR COMPARISON PURPOSES ONLY. THE COUNTY IS NOT RESPONSIBLE FOR ANY INACCURACIES HEREIN CONTAINED.

==== COGO =====

Wednesday May 31, 1995

12:31 PM

Coordinate File Name: SEC-26.CRD Lowest pt #: 1 Highest pt #: 99  
Job # : 95-27  
Description: COUNTY COORDINATES SECTION 26 T120 R26  
# of chars. in point descr.: 10

-----  
FROM TYPE BEARING DISTANCE TO NORTHING EASTING  
-----

LIST POINTS

POINT	NORTHING	EASTING	ELEVATION	DESCR
11	168491.429560	487745.572304		
13	169804.187825	487806.968482		
15	171116.946089	487868.364660		
17	172414.697341	487911.011993		
19	173712.448592	487953.659326		
31	168514.433960	489047.423766		
33	169823.470422	489105.273302		
35	171132.506883	489163.122837		
37	172432.516333	489211.534570		
39	173732.525783	489259.946302		
51	168537.438361	490349.275229		
53	169842.753019	490403.578122		
55	171148.067677	490457.881014		
57	172450.335325	490512.057146		
59	173752.602974	490566.233279		
71	168538.648391	491659.829426		
73	169851.229106	491713.779096		
75	171163.809821	491767.728767		
77	172469.882249	491804.952148		
79	173775.954677	491842.175530		
91	168539.858421	492970.383622		
93	169859.705194	493023.980071		
95	171179.551966	493077.576519		
97	172489.429173	493097.847150		
99	173799.306380	493118.117780		

START			11	168491.430	487745.572
11	INV N 2-40-39.7 E	2628.386	15	171116.946	487868.365
15	INV N 1-52-55.9 E	2596.904	19	173712.449	487953.659
19	INV N 89-07-10.0 E	2612.883	59	173752.603	490566.233
59	INV N 88-57-05.5 E	2552.312	99	173799.306	493118.118
<del>99</del>	<del>INV S 0-53-11.7 W</del>	<del>2620.068</del>	<del>95</del>	<del>171179.552</del>	<del>493077.577</del>
95	INV S 2-19-31.4 W	2641.869	91	168539.858	492970.384
91	INV S 89-56-49.6 W	2621.110	51	168537.438	490349.275
51	INV S 88-59-15.6 W	2604.109	11	168491.430	487745.572
START			51	168537.438	490349.275
51	INV N 2-22-56.0 E	2612.887	55	171148.068	490457.881
55	INV N 2-22-56.0 E	2606.788	59	173752.603	490566.233
START			15	171116.946	487868.365
15	INV N 89-18-41.2 E	2589.703	55	171148.068	490457.881
55	INV N 89-18-41.2 E	2619.885	95	171179.552	493077.577

POINT-POINT ANGLES

ANGLE	51 - 11 - 15:	C.W. 273-41-24.2	C.C.W. 86-18-35.8	2628.386
ANGLE	11 - 15 - 19:	C.W. 179-12-16.2	C.C.W. 180-47-43.8	2596.904
ANGLE	15 - 19 - 59:	C.W. 267-14-14.1	C.C.W. 92-45-45.9	2612.883
ANGLE	19 - 59 - 99:	C.W. 179-49-55.4	C.C.W. 180-10-04.6	2552.312
ANGLE	59 - 99 - 95:	C.W. 271-56-06.3	C.C.W. 88-03-53.7	2620.068
ANGLE	99 - 95 - 91:	C.W. 181-26-19.7	C.C.W. 178-33-40.3	2641.869
ANGLE	95 - 91 - 51:	C.W. 267-37-18.1	C.C.W. 92-22-41.9	2621.110
ANGLE	91 - 51 - 11:	C.W. 179-02-26.0	C.C.W. 180-57-34.0	2604.109

Coordinates stored

Wednesday May 31, 1995

12:32 PM