

WRIGHT COUNTY SURVEYORS OFFICE

Public Works Building  
Buffalo, Minn. 55313

SECTION 16 TOWNSHIP 120 RANGE 26

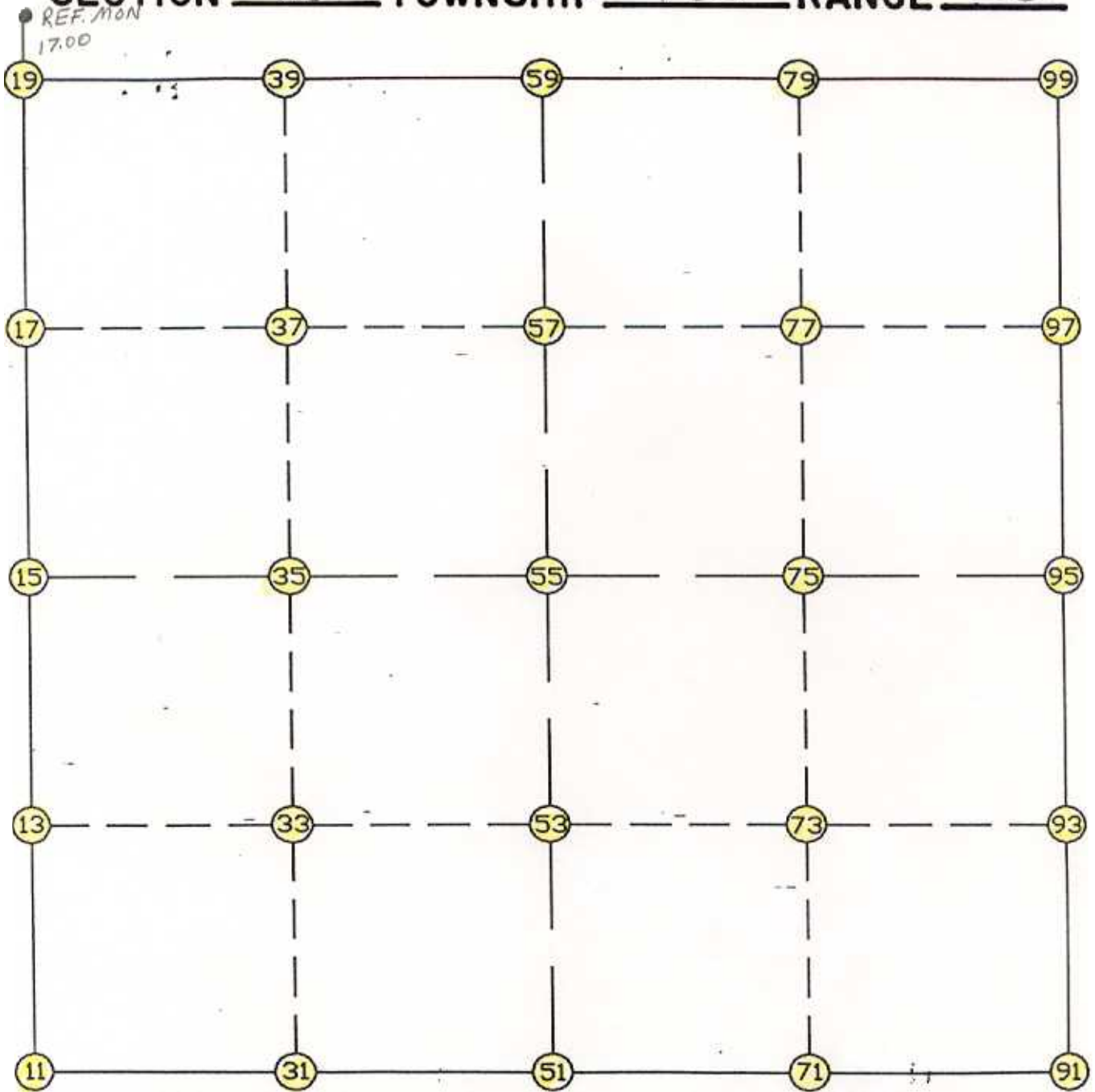

REMARKS

---

---

---

THE INFORMATION SHOWN HEREON IS A COMPILATION OF WRIGHT COUNTY RECORDS AND IS INTENDED TO BE USED FOR COMPARISON PURPOSES ONLY. THE COUNTY IS NOT RESPONSIBLE FOR ANY INACCURACIES HEREIN CONTAINED.

===== COGO =====

Tuesday May 30, 1995

1:36 PM

Coordinate File Name: SEC-16.CRD    Lowest pt #:    1    Highest pt #:    99  
Job #            : 95-27  
Description: COUNTY COORDINATES SECTION 16 T120 R26  
# of chars. in point descr.: 10

-----  
FROM TYPE            BEARING    DISTANCE    TO            NORTHING            EASTING  
-----

LIST POINTS

POINT	NORTHING	EASTING	ELEVATION	DESCR
11	179169.607677	477556.204654		
13	180459.556127	477525.339557		
15	181749.504577	477494.474460		
17	183092.076353	477508.333525		
19	184434.648128	477522.192589		
31	179137.015083	478900.753208		
33	180425.371303	478876.569947		
35	181713.727523	478852.386686		
37	183060.008682	478850.135529		
39	184406.289840	478847.884373		
51	179104.422490	480245.301763		
53	180391.186479	480227.800337		
55	181677.950468	480210.298911		
57	183027.941011	480191.937534		
59	184377.931553	480173.576157		
71	179067.119125	481589.567786		
73	180354.773968	481574.042680		
75	181642.428811	481558.517574		
77	183000.471919	481539.234481		
79	184358.515028	481519.951389		
91	179029.815760	482933.833810		
93	180318.361457	482920.285023		
95	181606.907154	482906.736236		
97	182973.002828	482886.531428		
99	184339.098503	482866.326621		

START			11	179169.608	477556.205	
11	INV N	1-22-14.4 W	2580.635	15	181749.505	477494.474
15	INV N	0-35-29.1 E	2685.287	19	184434.648	477522.193
19	INV S	88-46-28.4 E	2651.990	59	184377.932	480173.576
59	INV S	89-10-25.6 E	2693.030	99	184339.099	482866.327
99	INV S	0-50-50.5 E	2732.490	95	181606.907	482906.736
95	INV S	0-36-08.8 E	2577.234	91	179029.816	482933.834
91	INV N	88-24-37.6 W	2689.567	51	179104.422	480245.302
51	INV N	88-36-41.0 W	2689.887	11	179169.608	477556.205
START			51	179104.422	480245.302	
51	INV N	0-46-45.3 W	2573.766	55	181677.950	480210.299
55	INV N	0-46-45.3 W	2700.231	59	184377.932	480173.576
START			15	181749.505	477494.474	
15	INV S	88-29-26.8 E	2716.767	55	181677.950	480210.299
55	INV S	88-29-26.8 E	2697.373	95	181606.907	482906.736

POINT-POINT ANGLES

ANGLE	51 -	11 -	15:	C.W.	267-14-26.6	C.C.W.	92-45-33.4	2580.635
ANGLE	11 -	15 -	19:	C.W.	181-57-43.6	C.C.W.	178-02-16.4	2685.287
ANGLE	15 -	19 -	59:	C.W.	270-38-02.5	C.C.W.	89-21-57.5	2651.990
ANGLE	19 -	59 -	99:	C.W.	179-36-02.8	C.C.W.	180-23-57.2	2693.030
ANGLE	59 -	99 -	95:	C.W.	268-19-35.1	C.C.W.	91-40-24.9	2732.490
ANGLE	99 -	95 -	91:	C.W.	180-14-41.7	C.C.W.	179-45-18.3	2577.234
ANGLE	95 -	91 -	51:	C.W.	272-11-31.1	C.C.W.	87-48-28.9	2689.567
ANGLE	91 -	51 -	11:	C.W.	179-47-56.6	C.C.W.	180-12-03.4	2689.887

Coordinates stored

Tuesday May 30, 1995

1:37 PM