

WRIGHT COUNTY SURVEYORS OFFICE

Public Works Building
Buffalo, Minn. 55313

SECTION 9 TOWNSHIP 120 RANGE 26

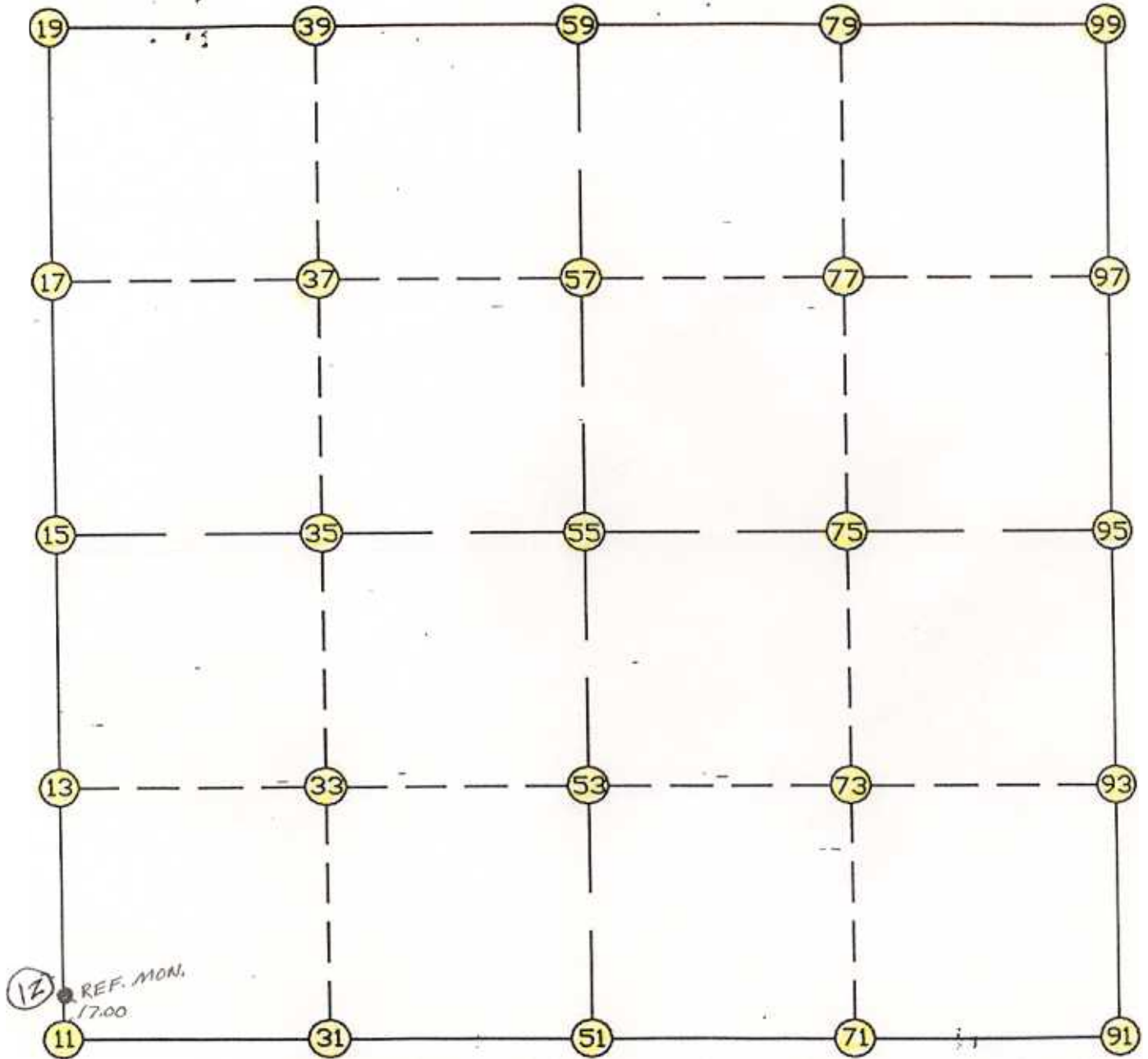

REMARKS

THE INFORMATION SHOWN HEREON IS A COMPILATION OF WRIGHT COUNTY RECORDS AND IS INTENDED TO BE USED FOR COMPARISON PURPOSES ONLY. THE COUNTY IS NOT RESPONSIBLE FOR ANY INACCURACIES HEREIN CONTAINED.

Coordinate File Name: SEC-09.CRD Lowest pt #: 1 Highest pt #: 99
 Job # : 95-27
 Description: COUNTY COORDINATES SECTION 9 T120 R26
 # of chars. in point descr.: 10

 FROM TYPE BEARING DISTANCE TO NORTHING EASTING

LIST POINTS

POINT	NORTHING	EASTING	ELEVATION	DESCR
11	184434.648128	477522.192589		
13	185761.091239	477492.824760		
15	187087.534350	477463.456930		
17	188498.651121	477477.260324		
19	189909.767892	477491.063717		
31	184406.289840	478847.884373		
33	185774.273400	478835.924192		
35	187142.256960	478823.964012		
37	188530.609057	478833.504540		
39	189918.961154	478843.045069		
51	184377.931553	480173.576157		
53	185787.455561	480179.023625		
55	187196.979570	480184.471093		
57	188562.566993	480189.748757		
59	189928.154417	480195.026421		
71	184358.515028	481519.951389		
73	185804.323693	481512.950421		
75	187250.132358	481505.949454		
77	188595.466914	481507.912492		
79	189940.801469	481509.875529		
91	184339.098503	482866.326621		
93	185821.191825	482846.877218		
95	187303.285147	482827.427814		
97	188628.366834	482826.076226		
99	189953.448521	482824.724638		

START			11	184434.648	477522.193	
11	INV N	1-16-06.0 W	2653.536	15	187087.534	477463.457
15	INV N	0-33-37.6 E	2822.369	19	189909.768	477491.064
19	INV N	89-36-37.5 E	2704.025	59	189928.154	480195.026
59	INV N	89-26-56.1 E	2629.820	99	189953.449	482824.725
99	INV S	0-03-30.4 E	2650.165	95	187303.285	482827.428
95	INV S	0-45-06.6 E	2964.442	91	184339.099	482866.327
91	INV N	89-10-25.6 W	2693.030	51	184377.932	480173.576
51	INV N	88-46-28.4 W	2651.990	11	184434.648	477522.193
START			51	184377.932	480173.576	
51	INV N	0-13-17.2 E	2819.069	55	187196.980	480184.471
55	INV N	0-13-17.2 E	2731.195	59	189928.154	480195.026
START			15	187087.534	477463.457	
15	INV N	87-41-48.0 E	2723.214	55	187196.980	480184.471
55	INV N	87-41-48.0 E	2645.094	95	187303.285	482827.428

POINT-POINT ANGLES

ANGLE	51 -	11 -	15:	C.W.	267-30-22.4	C.C.W.	92-29-37.6	2653.536
ANGLE	11 -	15 -	19:	C.W.	181-49-43.6	C.C.W.	178-10-16.4	2822.369
ANGLE	15 -	19 -	59:	C.W.	269-02-59.9	C.C.W.	90-57-00.1	2704.025
ANGLE	19 -	59 -	99:	C.W.	179-50-18.6	C.C.W.	180-09-41.4	2629.820
ANGLE	59 -	99 -	95:	C.W.	270-29-33.5	C.C.W.	89-30-26.5	2650.165
ANGLE	99 -	95 -	91:	C.W.	179-18-23.7	C.C.W.	180-41-36.3	2964.442
ANGLE	95 -	91 -	51:	C.W.	271-34-41.0	C.C.W.	88-25-19.0	2693.030
ANGLE	91 -	51 -	11:	C.W.	180-23-57.2	C.C.W.	179-36-02.8	2651.990