

WRIGHT COUNTY SURVEYORS OFFICE

Public Works Building
Buffalo, Minn. 55313

SECTION 9 TOWNSHIP 120 RANGE 23

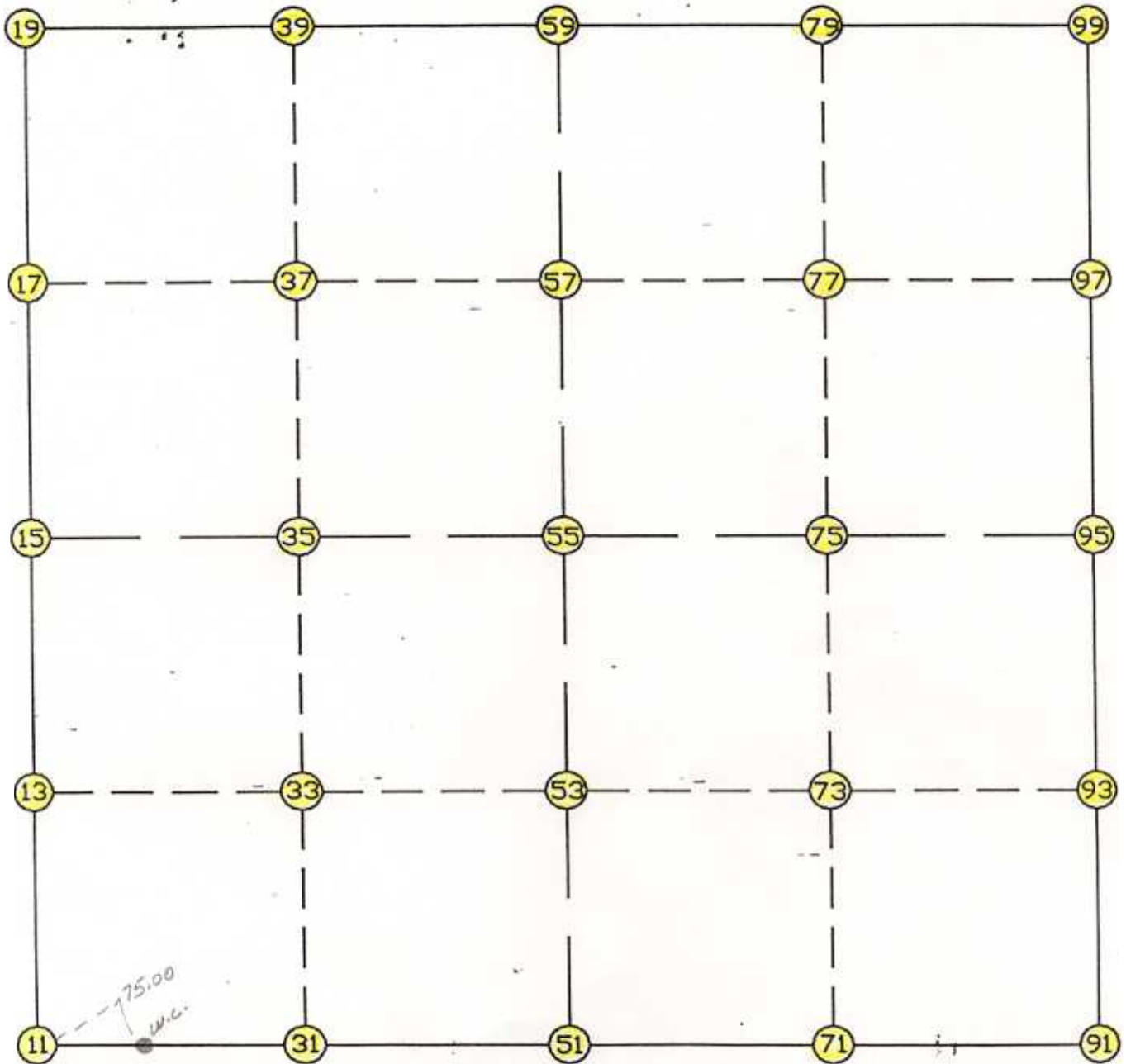

REMARKS

THE INFORMATION SHOWN HEREON IS A COMPILATION OF WRIGHT COUNTY RECORDS AND IS INTENDED TO BE USED FOR COMPARISON PURPOSES ONLY. THE COUNTY IS NOT RESPONSIBLE FOR ANY INACCURACIES HEREIN CONTAINED.

POINT	NORTHING	EASTING	ELEVATION	DESCR
11	185050.090258	572032.319745		
13	186336.575247	572031.604189		
15	187623.060236	572030.888633		
17	188909.505975	572040.959531		
19	190195.951715	572051.030430		
31	185060.028131	573344.521898		
33	186354.477328	573340.925339		
35	187648.926525	573337.328779		
37	188924.597515	573339.218743		
39	190200.268506	573341.108707		
51	185069.966003	574656.724052		
53	186372.379409	574650.246489		
55	187674.792814	574643.768926		
57	188939.689056	574637.477954		
59	190204.585297	574631.186983		
71	185079.201677	575968.689510		
73	186390.405460	575983.443847		
75	187701.609242	575998.198184		
77	188963.319595	575988.693867		
79	190225.029948	575979.189550		
91	185088.437351	577280.654969		
93	186408.431511	577316.641206		
95	187728.425671	577352.627443		
97	188986.950135	577339.909780		
99	190245.474599	577327.192117		

START				11	185050.090	572032.320
11	INV N	0-01-54.7 W	2572.970	15	187623.060	572030.889
15	INV N	0-26-54.7 E	2572.970	19	190195.952	572051.030
19	INV N	89-48-29.8 E	2580.171	59	190204.585	574631.187
59	INV N	89-07-51.9 E	2696.315	99	190245.475	577327.192
99	INV S	0-34-44.3 E	2517.177	95	187728.426	577352.627
95	INV S	1-33-41.9 W	2640.969	91	185088.437	577280.655
91	INV S	89-35-48.0 W	2623.996	51	185069.966	574656.724
51	INV S	89-33-57.9 W	2624.480	11	185050.090	572032.320

START				51	185069.966	574656.724
51	INV N	0-17-05.9 W	2604.859	55	187674.793	574643.769
55	INV N	0-17-05.9 W	2529.824	59	190204.585	574631.187
START				15	187623.060	572030.889
15	INV N	88-51-56.7 E	2613.392	55	187674.793	574643.769
55	INV N	88-51-56.7 E	2709.389	95	187728.426	577352.627

POINT-POINT ANGLES

ANGLE	51 -	11 -	15:	C.W.	270-24-07.4	C.C.W.	89-35-52.6	2572.970
ANGLE	11 -	15 -	19:	C.W.	180-28-49.4	C.C.W.	179-31-10.6	2572.970
ANGLE	15 -	19 -	59:	C.W.	269-21-35.1	C.C.W.	90-38-24.9	2580.171
ANGLE	19 -	59 -	99:	C.W.	179-19-22.1	C.C.W.	180-40-37.9	2696.315
ANGLE	59 -	99 -	95:	C.W.	270-17-23.8	C.C.W.	89-42-36.2	2517.177
ANGLE	99 -	95 -	91:	C.W.	182-08-26.2	C.C.W.	177-51-33.8	2640.969
ANGLE	95 -	91 -	51:	C.W.	268-02-06.1	C.C.W.	91-57-53.9	2623.996
ANGLE	91 -	51 -	11:	C.W.	179-58-09.9	C.C.W.	180-01-50.1	2624.480

Coordinates stored

Thursday January 26, 1995

1:56 PM