

WRIGHT COUNTY SURVEYORS OFFICE

Public Works Building  
Buffalo, Minn. 55313

SECTION 11 TOWNSHIP 119 RANGE 28

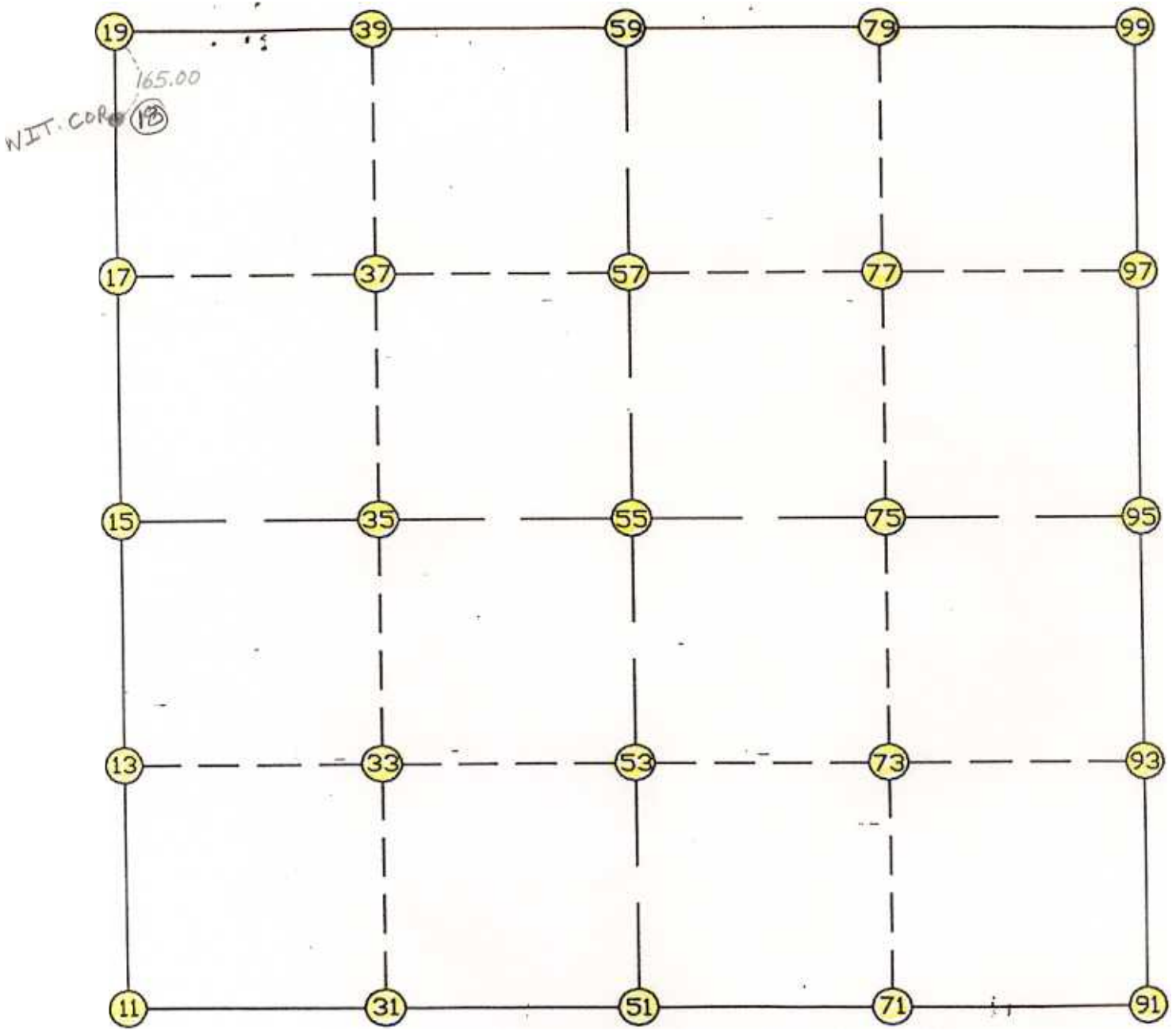

REMARKS

---

---

---

THE INFORMATION SHOWN HEREON IS A COMPILATION OF WRIGHT COUNTY RECORDS AND IS INTENDED TO BE USED FOR COMPARISON PURPOSES ONLY. THE COUNTY IS NOT RESPONSIBLE FOR ANY INACCURACIES HEREIN CONTAINED.

== COGO =====

Friday February 24, 1995

10:36 AM

Coordinate File Name: SEC-11.CRD    Lowest pt #:    1    Highest pt #:    99  
Job #            : 95-15  
Description: COUNTY COORDINATES SECTION 11 T119 R28  
# of chars. in point descr.: 10

FROM TYPE	BEARING	DISTANCE	TO	NORTHING	EASTING
-----					
LIST POINTS					
POINT	NORTHING	EASTING	ELEVATION	DESCR	
-----					
11	153120.918817	424896.926601			
13	154438.886335	424965.332943			
15	155756.853854	425033.739285			
17	157075.724616	425102.202941			
19	158394.595377	425170.666597			
31	153126.944572	426145.921731			
33	154449.970983	426219.970040			
35	155772.997393	426294.018348			
37	157093.434560	426367.912850			
39	158413.871727	426441.807352			
51	153132.970328	427394.916861			
53	154461.055630	427474.607136			
55	155789.140932	427554.297411			
57	157111.144505	427633.622759			
59	158433.148077	427712.948107			
71	153144.515283	428711.901383			
73	154475.111485	428779.758502			
75	155805.707686	428847.615622			
77	157130.764521	428921.072563			
79	158455.821355	428994.529505			
91	153156.060238	430028.885905			
93	154489.167339	430084.909869			
95	155822.274440	430140.933833			
97	157150.384537	430208.522368			
99	158478.494634	430276.110902			

START					11	153120.919	424896.927
	11	INV N	2-58-16.1 E	2639.483	15	155756.854	425033.739
	15	INV N	2-58-17.8 E	2641.293	19	158394.595	425170.667
	19	INV N	89-07-52.3 E	2542.574	59	158433.148	427712.948
	59	INV N	88-59-11.2 E	2563.564	99	158478.495	430276.111
	99	INV S	2-54-47.9 W	2659.658	95	155822.274	430140.934
	95	INV S	2-24-23.2 W	2668.568	91	153156.060	430028.886
	91	INV S	89-29-51.9 W	2634.070	51	153132.970	427394.917
	51	INV S	89-43-24.9 W	2498.019	11	153120.919	424896.927
START					51	153132.970	427394.917
	51	INV N	3-26-01.9 E	2660.948	55	155789.141	427554.297
	55	INV N	3-26-01.9 E	2648.763	59	158433.148	427712.948
START					15	155756.854	425033.739
	15	INV N	89-15-58.0 E	2520.765	55	155789.141	427554.297
	55	INV N	89-15-58.0 E	2586.849	95	155822.274	430140.934

POINT-POINT ANGLES

ANGLE	51 -	11 -	15:	C.W.	273-14-51.3	C.C.W.	86-45-08.7	2639.483
ANGLE	11 -	15 -	19:	C.W.	180-00-01.6	C.C.W.	179-59-58.4	2641.293
ANGLE	15 -	19 -	59:	C.W.	266-09-34.5	C.C.W.	93-50-25.5	2542.574
ANGLE	19 -	59 -	99:	C.W.	179-51-18.9	C.C.W.	180-08-41.1	2563.564
ANGLE	59 -	99 -	95:	C.W.	273-55-36.7	C.C.W.	86-04-23.3	2659.658
ANGLE	99 -	95 -	91:	C.W.	179-29-35.3	C.C.W.	180-30-24.7	2668.568
ANGLE	95 -	91 -	51:	C.W.	267-05-28.7	C.C.W.	92-54-31.3	2634.070
ANGLE	91 -	51 -	11:	C.W.	180-13-33.0	C.C.W.	179-46-27.0	2498.019

Coordinates stored

Friday February 24, 1995

10:37 AM