

WRIGHT COUNTY SURVEYORS OFFICE
Public Works Building
Buffalo, Minn. 55313

SECTION 3 TOWNSHIP 119 RANGE 28

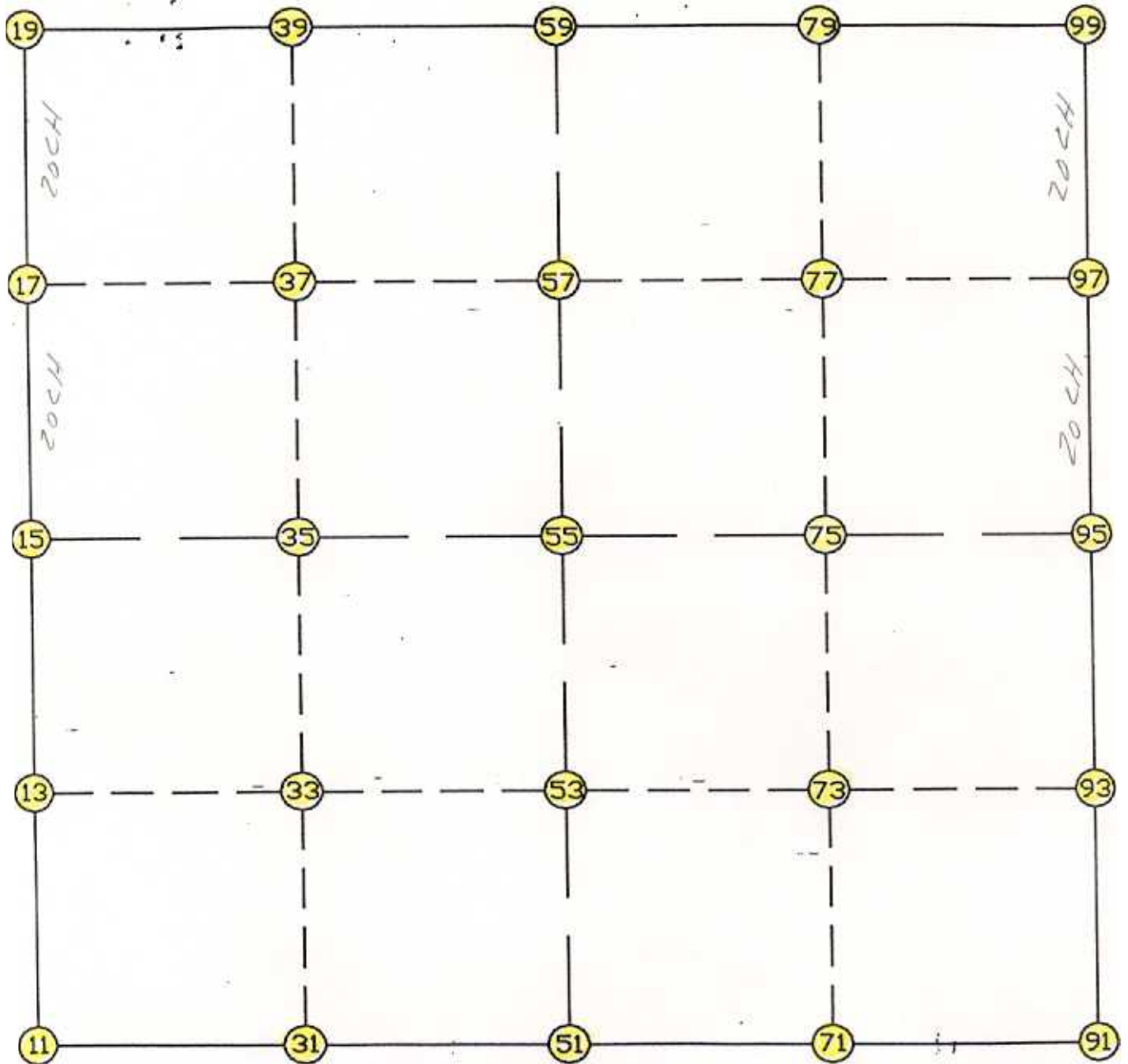

REMARKS

THE INFORMATION SHOWN HEREON IS A COMPILATION OF WRIGHT COUNTY RECORDS AND IS INTENDED TO BE USED FOR COMPARISON PURPOSES ONLY. THE COUNTY IS NOT RESPONSIBLE FOR ANY INACCURACIES HEREIN CONTAINED.

COGO =====

Thursday February 23, 1995

11:51 AM

Coordinate File Name: SEC-03.CRD Lowest pt #: 1 Highest pt #: 99
Job # : 95-15
Description: COUNTY COORDINATES SECTION 3 T119 R28
of chars. in point descr.: 10

FROM	TYPE	BEARING	DISTANCE	TO	NORTHING	EASTING
LIST POINTS						
POINT		NORTHING	EASTING	ELEVATION	DESCR	
11		158589.274489	419483.780912			
13		159932.914576	419459.996831			
15		161276.554664	419436.212750			
17		162618.068832	419413.402375			
19		163959.583000	419390.592000			
31		158540.457658	420909.764822			
33		159891.462489	420858.089134			
35		161242.467319	420806.413446			
37		162593.543694	420755.158156			
39		163944.620070	420703.902866			
51		158491.640827	422335.748733			
53		159850.010401	422256.181437			
55		161208.379974	422176.614141			
57		162569.018557	422096.913936			
59		163929.657139	422017.213731			
71		158443.118102	423753.207665			
73		159808.703644	423650.080464			
75		161174.289185	423546.953263			
77		162544.538674	423441.050855			
79		163914.788163	423335.148448			
91		158394.595377	425170.666597			
93		159767.396887	425043.979491			
95		161140.198396	424917.292385			
97		162520.058791	424785.187774			
99		163899.919186	424653.083164			

START					11	158589.274	419483.781
11	INV N	1-00-50.8 W	2687.701		15	161276.555	419436.213
15	INV N	0-58-26.9 W	2683.416		19	163959.583	419390.592
19	INV S	89-20-50.1 E	2626.792		59	163929.657	422017.214
59	INV S	89-21-13.0 E	2636.037		99	163899.919	424653.083
99	INV S	5-28-07.3 E	2772.339		95	161140.198	424917.292
95	INV S	5-16-21.1 E	2757.269		91	158394.595	425170.667
91	INV N	88-02-21.9 W	2836.578		51	158491.641	422335.749
51	INV N	88-02-21.5 W	2853.639		11	158589.274	419483.781
START					51	158491.641	422335.749
51	INV N	3-21-08.3 W	2721.396		55	161208.380	422176.614
55	INV N	3-21-08.3 W	2725.942		59	163929.657	422017.214
START					15	161276.555	419436.213
15	INV S	88-34-29.7 E	2741.249		55	161208.380	422176.614
55	INV S	88-34-29.7 E	2741.526		95	161140.198	424917.292

POINT-POINT ANGLES

ANGLE	51 -	11 -	15:	C.W.	267-01-30.8	C.C.W.	92-58-29.2	2687.701
ANGLE	11 -	15 -	19:	C.W.	180-02-23.9	C.C.W.	179-57-36.1	2683.416
ANGLE	15 -	19 -	59:	C.W.	271-37-36.8	C.C.W.	88-22-23.2	2626.792
ANGLE	19 -	59 -	99:	C.W.	179-59-37.1	C.C.W.	180-00-22.9	2636.037
ANGLE	59 -	99 -	95:	C.W.	263-53-05.7	C.C.W.	96-06-54.3	2772.339
ANGLE	99 -	95 -	91:	C.W.	180-11-46.2	C.C.W.	179-48-13.8	2757.269
ANGLE	95 -	91 -	51:	C.W.	277-13-59.2	C.C.W.	82-46-00.8	2836.578
ANGLE	91 -	51 -	11:	C.W.	180-00-00.3	C.C.W.	179-59-59.7	2853.639

Coordinates stored

Thursday February 23, 1995

11:53 AM