

WRIGHT COUNTY SURVEYORS OFFICE

Public Works Building
Buffalo, Minn. 55313

SECTION 18 TOWNSHIP 119 RANGE 27

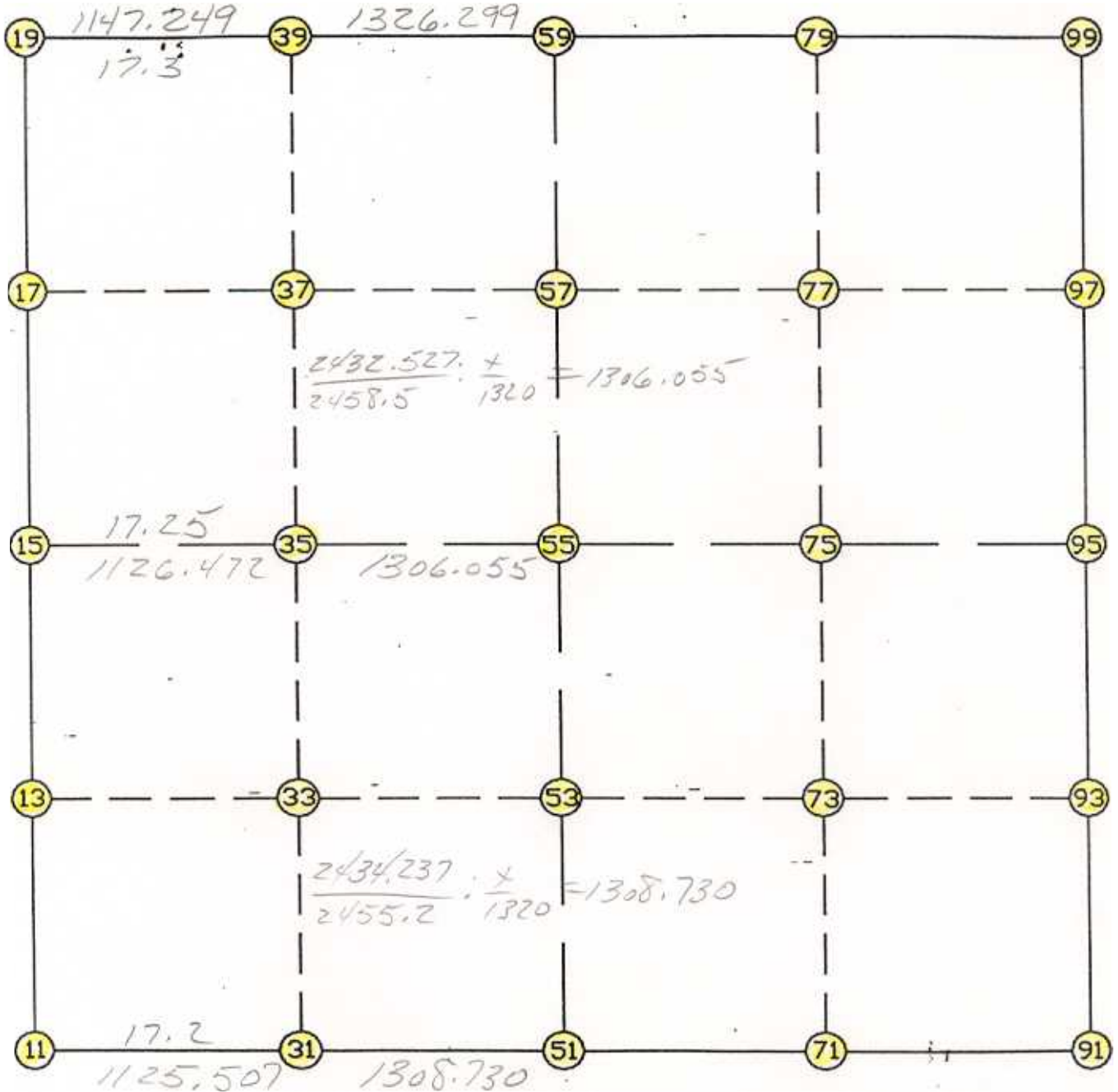

REMARKS

THE INFORMATION SHOWN HEREON IS A COMPILATION OF WRIGHT COUNTY RECORDS AND IS INTENDED TO BE USED FOR COMPARISON PURPOSES ONLY. THE COUNTY IS NOT RESPONSIBLE FOR ANY INACCURACIES HEREIN CONTAINED.

Coordinate File Name: SEC-18.CRD Lowest pt #: 1 Highest pt #: 99
 Job # : 95-15
 Description: COUNTY COORDINATES SECTION 18 T119 R27
 # of chars. in point descr.: 10

FROM	TYPE	BEARING	DISTANCE	TO	NORTHING	EASTING
LIST POINTS						
POINT					NORTHING	EASTING
11					147946.214000	435195.351000
13					149267.375722	435204.743711
15					150588.537444	435214.136421
17					151904.021479	435202.273763
19					153219.505514	435190.411104
31					147947.717112	436320.857292
33					149267.962609	436330.732838
35					150588.206676	436340.608373
37					151909.292862	436339.108437
39					153230.387680	436337.608492
51					147949.464917	437629.586125
53					149268.644046	437638.124483
55					150587.823176	437646.662841
57					151915.395697	437655.255524
59					153242.968218	437663.848208
71					147941.636485	438948.061786
73					149264.536513	438955.728509
75					150587.436541	438963.395231
77					151914.472128	438975.283673
79					153241.507715	438987.172114
91					147933.808054	440266.537447
93					149260.428980	440273.332534
95					150587.049906	440280.127621
97					151913.548559	440295.311821
99					153240.047211	440310.496020

START				11	147946.214	435195.351	24
11	INV N	0-24-26.4 E	2642.390	15	150588.537	435214.136	
15	INV N	0-31-00.0 W	2631.075	19	153219.506	435190.411	
19	INV N	89-27-23.5 E	2473.548	59	153242.968	437663.848	
59	INV S	89-56-12.4 E	2646.649	99	153240.047	440310.496	18
99	INV S	0-39-21.0 W	2653.171	95	150587.050	440280.128	
95	INV S	0-17-36.5 W	2653.277	91	147933.808	440266.537	
91	INV N	89-39-35.3 W	2636.998	51	147949.465	437629.586	
51	INV S	89-55-24.5 W	2434.237	11	147946.214	435195.351	24

START				51	147949.465	437629.586	
51	INV N	0-22-15.0 E	2638.414	55	150587.823	437646.663	
55	INV N	0-22-15.0 E	2655.201	59	153242.968	437663.848	

START				15	150588.537	435214.136	
15	INV S	89-58-59.4 E	2432.527	55	150587.823	437646.663	
55	INV S	89-58-59.4 E	2633.465	95	150587.050	440280.128	

POINT-POINT ANGLES							
ANGLE	51 -	11 -	15:	C.W.	270-29-01.9	C.C.W.	89-30-58.1 2642.390
ANGLE	11 -	15 -	19:	C.W.	179-04-33.6	C.C.W.	180-55-26.4 2631.075
ANGLE	15 -	19 -	59:	C.W.	269-58-23.4	C.C.W.	90-01-36.6 2473.548
ANGLE	19 -	59 -	99:	C.W.	180-36-24.2	C.C.W.	179-23-35.8 2646.649
ANGLE	59 -	99 -	95:	C.W.	270-35-33.3	C.C.W.	89-24-26.7 2653.171
ANGLE	99 -	95 -	91:	C.W.	179-38-15.5	C.C.W.	180-21-44.5 2653.277
ANGLE	95 -	91 -	51:	C.W.	270-02-48.2	C.C.W.	89-57-11.8 2636.998
ANGLE	91 -	51 -	11:	C.W.	179-34-59.9	C.C.W.	180-25-00.1 2434.237