

WRIGHT COUNTY SURVEYORS OFFICE

Public Works Building
Buffalo, Minn. 55313

SECTION 10 TOWNSHIP 119 RANGE 27

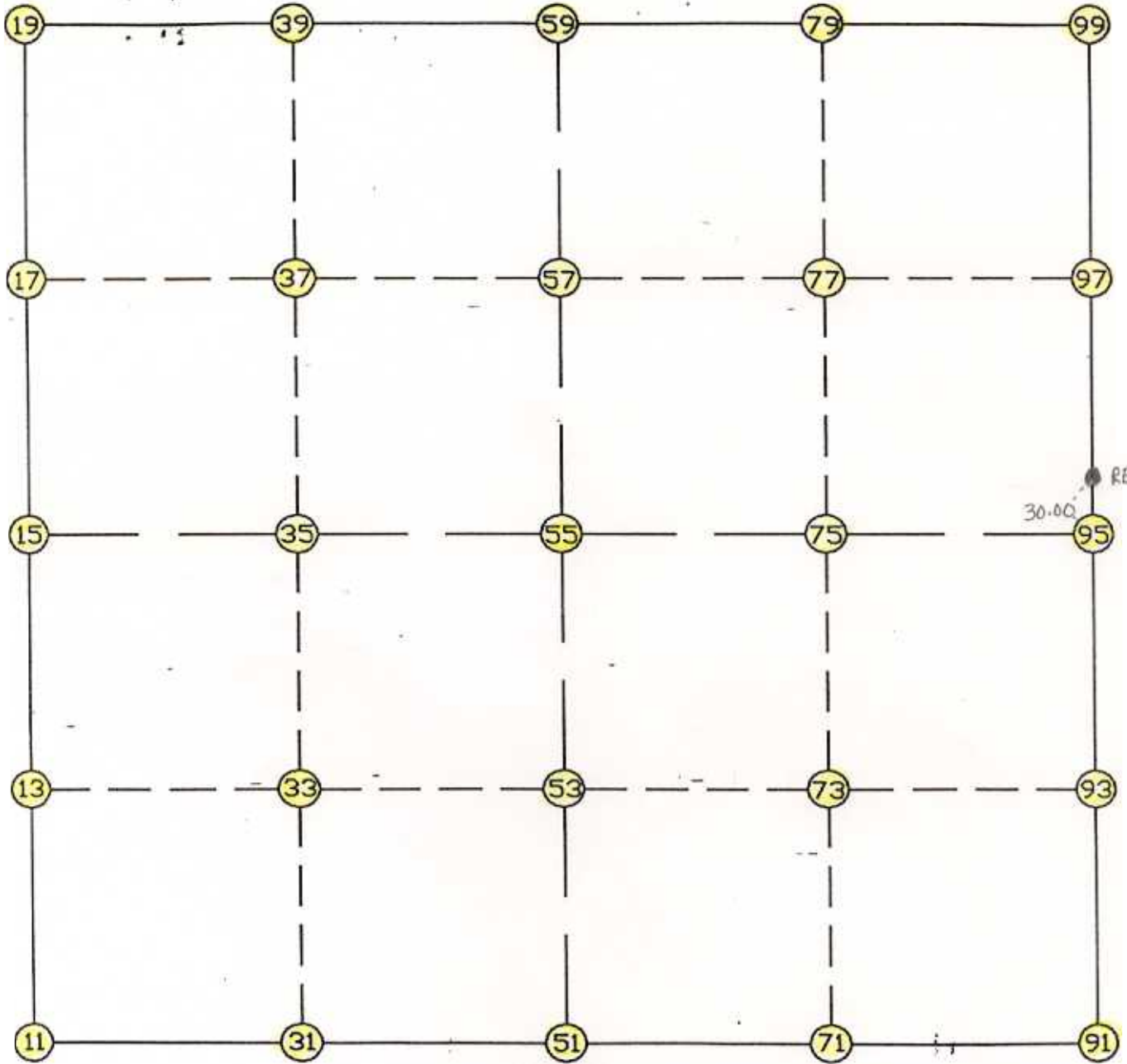

REMARKS

THE INFORMATION SHOWN HEREON IS A COMPILATION OF WRIGHT COUNTY RECORDS AND IS INTENDED TO BE USED FOR COMPARISON PURPOSES ONLY. THE COUNTY IS NOT RESPONSIBLE FOR ANY INACCURACIES HEREIN CONTAINED.

Coordinate File Name: SEC-10.CRD Lowest pt #: 1 Highest pt #: 99
 Job # : 95-15
 Description: COUNTY COORDINATES SECTION 10 T119 R27
 # of chars. in point descr.: 10

 FROM TYPE BEARING DISTANCE TO NORTHING EASTING

LIST POINTS

POINT	NORTHING	EASTING	ELEVATION	DESCR
11	153222.273154	450931.763012		
13	154549.039990	450936.136838		
15	155875.806825	450940.510665		
17	157203.784004	450944.782288		
19	158531.761182	450949.053911		
31	153197.257053	452245.958367		
33	154533.791125	452249.954021		
35	155870.325196	452253.949675		
37	157201.694388	452257.878723		
39	158533.063580	452261.807771		
51	153172.240951	453560.153723		
53	154518.542259	453563.771204		
55	155864.843568	453567.388685		
57	157199.604773	453570.975158		
59	158534.365979	453574.561632		
71	153186.894461	454882.858240		
73	154523.129505	454881.530182		
75	155859.364550	454880.202123		
77	157197.514799	454885.090064		
79	158535.665048	454889.978005		
91	153201.547970	456205.562758		
93	154527.716751	456199.289160		
95	155853.885532	456193.015561		
97	157195.424824	456199.204970		
99	158536.964117	456205.394378		

START			11	153222.273	450931.763
11	INV N	0-11-20.0 E	2653.548	15	155875.807
15	INV N	0-11-03.5 E	2655.968	19	158531.761
19	INV N	89-56-35.4 E	2625.509	59	158534.366
59	INV N	89-56-36.3 E	2630.834	99	158536.964
99	INV S	0-15-51.6 W	2683.107	95	155853.886
95	INV S	0-16-15.8 E	2652.367	91	153201.548
91	INV S	89-21-55.0 W	2645.571	51	153172.241
51	INV N	88-54-34.2 W	2628.867	11	153222.273
START			51	153172.241	453560.154
51	INV N	0-09-14.2 E	2692.612	55	155864.844
55	INV N	0-09-14.2 E	2669.532	59	158534.366
START			15	155875.807	450940.511
15	INV S	89-45-39.2 E	2626.901	55	155864.844
55	INV S	89-45-39.2 E	2625.650	95	155853.886

POINT-POINT ANGLES

ANGLE	51 -	11 -	15:	C.W.	269-05-54.1	C.C.W.	90-54-05.9	2653.548
ANGLE	11 -	15 -	19:	C.W.	179-59-43.5	C.C.W.	180-00-16.5	2655.968
ANGLE	15 -	19 -	59:	C.W.	269-45-31.9	C.C.W.	90-14-28.1	2625.509
ANGLE	19 -	59 -	99:	C.W.	180-00-00.9	C.C.W.	179-59-59.1	2630.834
ANGLE	59 -	99 -	95:	C.W.	270-19-15.3	C.C.W.	89-40-44.7	2683.107
ANGLE	99 -	95 -	91:	C.W.	179-27-52.6	C.C.W.	180-32-07.4	2652.367
ANGLE	95 -	91 -	51:	C.W.	269-38-10.8	C.C.W.	90-21-49.2	2645.571
ANGLE	91 -	51 -	11:	C.W.	181-43-30.8	C.C.W.	178-16-29.2	2628.867