

WRIGHT COUNTY SURVEYORS OFFICE

Public Works Building
Buffalo, Minn. 55313

SECTION 5 TOWNSHIP 119 RANGE 27

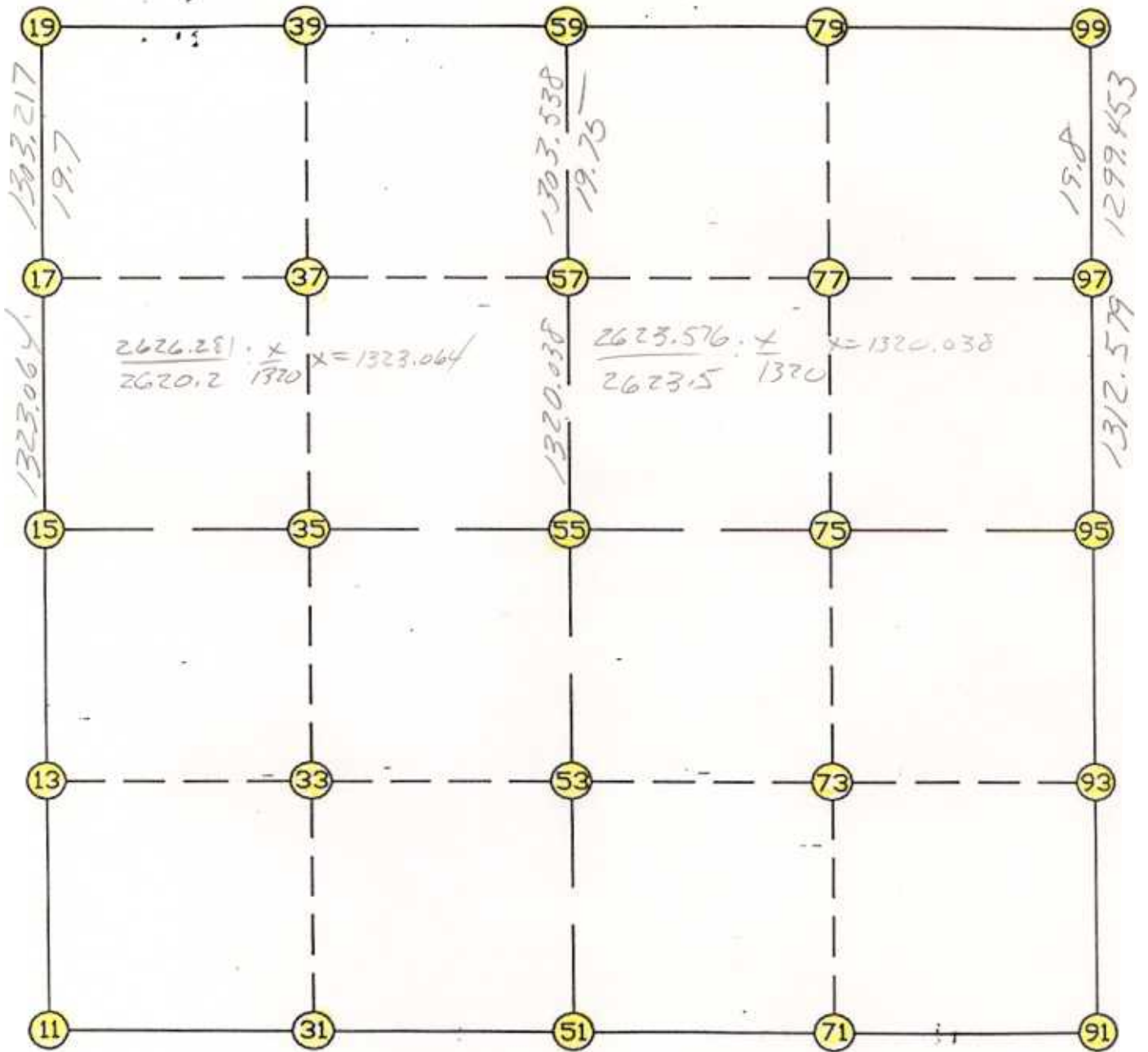

REMARKS

THE INFORMATION SHOWN HEREON IS A COMPILATION OF WRIGHT COUNTY RECORDS AND IS INTENDED TO BE USED FOR COMPARISON PURPOSES ONLY. THE COUNTY IS NOT RESPONSIBLE FOR ANY INACCURACIES HEREIN CONTAINED.

COGO =====

Wednesday March 1, 1995

12:38 PM

Coordinate File Name: SEC-05.CRD Lowest pt #: 1 Highest pt #: 99
 Job # : 95-15
 Description: COUNTY COORDINATES SECTION 5 T119 R27
 # of chars. in point descr.: 10

FROM TYPE	BEARING	DISTANCE	TO	NORTHING	EASTING
LIST POINTS					
POINT	NORTHING	EASTING	ELEVATION	DESCR	
11	158518.033511	440325.388822			
13	159837.939879	440330.950616			
15	161157.846247	440336.512410			
17	162480.489121	440369.891703			
19	163783.291643	440402.770289			
31	158511.256067	441659.721720			
33	159836.176373	441669.577431			
35	161161.096678	441679.433143			
37	162482.399754	441703.138490			
39	163785.533340	441726.517859			
51	158504.478624	442994.054618			
53	159834.412866	443008.204247			
55	161164.347109	443022.353876			
57	162484.310404	443036.397420			
59	163787.775037	443050.265430			
71	158520.765386	444321.822343			
73	159844.157115	444333.489308			
75	161167.548844	444345.156274			
77	162483.777967	444359.626999			
79	163785.194935	444373.934878			
91	158537.052149	445649.590068			
93	159853.901364	445658.774370			
95	161170.750580	445667.958672			
97	162483.245530	445682.855990			
99	163782.614833	445697.604327			

START			11	158518.034	440325.389
11	INV N	0-14-29.1 E	2639.836	15	161157.846
15	INV N	1-26-44.4 E	2626.281	19	163783.292
19	INV N	89-54-10.7 E	2647.499	59	163787.775
59	INV S	89-53-17.9 E	2647.344	99	163782.615
99	INV S	0-39-01.1 W	2612.032	95	161170.751
95	INV S	0-23-58.6 W	2633.762	91	158537.052
91	INV S	89-17-50.0 W	2655.735	51	158504.479
51	INV N	89-42-32.3 W	2668.700	11	158518.034

START			51	158504.479	442994.055
51	INV N	0-36-34.4 E	2660.019	55	161164.347
55	INV N	0-36-34.4 E	2623.576	59	163787.775

START			15	161157.846	440336.512
15	INV N	89-51-40.8 E	2685.849	55	161164.347
55	INV N	89-51-40.8 E	2645.613	95	161170.751

POINT-POINT ANGLES								
ANGLE	51 -	11 -	15:	C.W.	269-57-01.5	C.C.W.	90-02-58.5	2639.836
ANGLE	11 -	15 -	19:	C.W.	181-12-15.2	C.C.W.	178-47-44.8	2626.281
ANGLE	15 -	19 -	59:	C.W.	268-27-26.3	C.C.W.	91-32-33.7	2647.499
ANGLE	19 -	59 -	99:	C.W.	180-12-31.3	C.C.W.	179-47-28.7	2647.344
ANGLE	59 -	99 -	95:	C.W.	270-32-19.0	C.C.W.	89-27-41.0	2612.032
ANGLE	99 -	95 -	91:	C.W.	179-44-57.5	C.C.W.	180-15-02.5	2633.762
ANGLE	95 -	91 -	51:	C.W.	268-53-51.5	C.C.W.	91-06-08.5	2655.735
ANGLE	91 -	51 -	11:	C.W.	180-59-37.6	C.C.W.	179-00-22.4	2668.700

Coordinates stored

Wednesday March 1, 1995

12:39 PM