

WRIGHT COUNTY SURVEYORS OFFICE

Public Works Building
Buffalo, Minn. 55313

SECTION 3 TOWNSHIP 119 RANGE 27

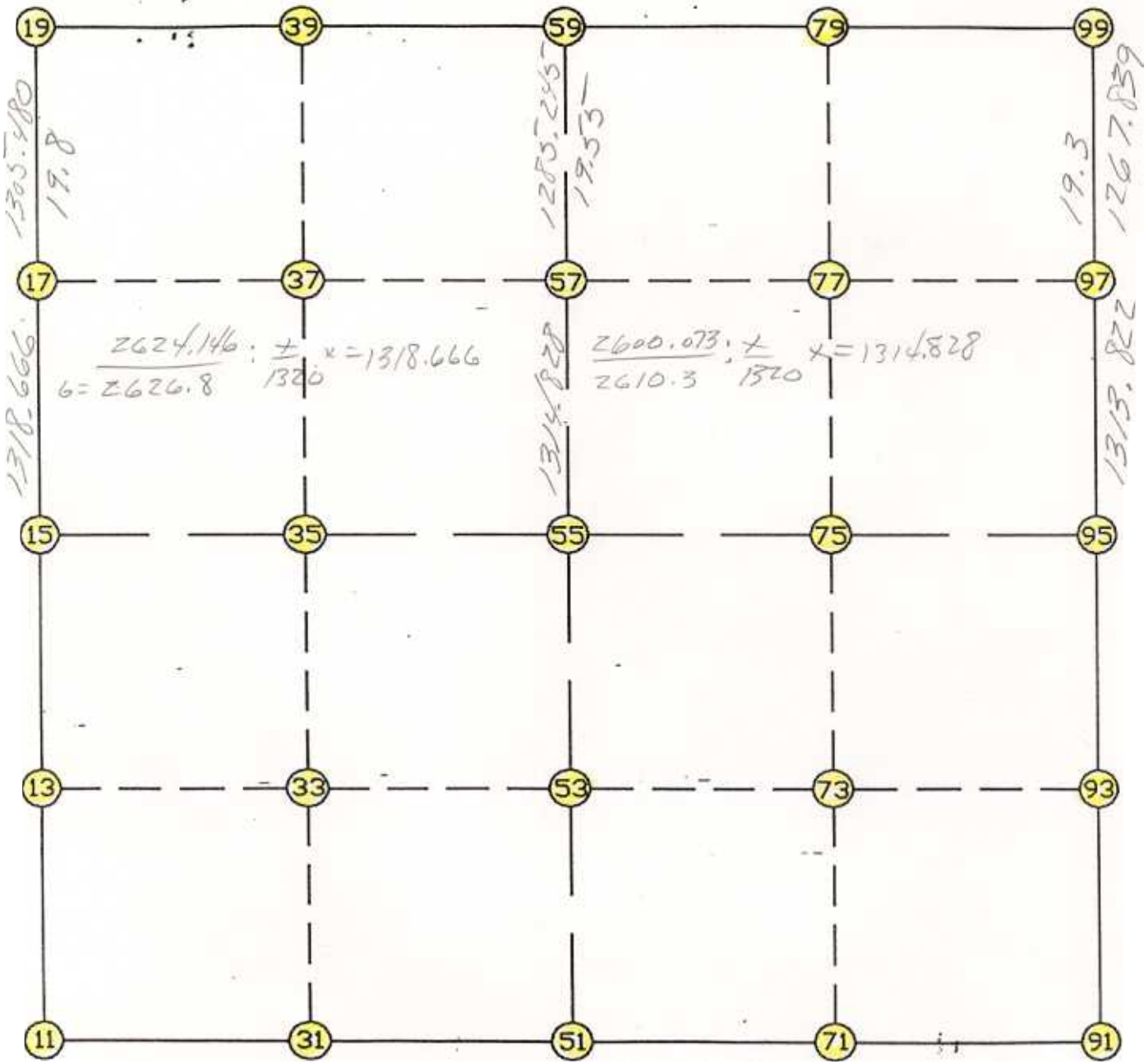

REMARKS

THE INFORMATION SHOWN HEREON IS A COMPILATION OF WRIGHT COUNTY RECORDS AND IS INTENDED TO BE USED FOR COMPARISON PURPOSES ONLY. THE COUNTY IS NOT RESPONSIBLE FOR ANY INACCURACIES HEREIN CONTAINED.

Coordinate File Name: SEC-03.CRD Lowest pt #: 1 Highest pt #: 99
 Job # : 95-15
 Description: COUNTY COORDINATES SECTION 3 T119 R27
 # of chars. in point descr.: 10

FROM TYPE	BEARING	DISTANCE	TO	NORTHING	EASTING
LIST POINTS					
POINT	NORTHING	EASTING	ELEVATION	DESCR	
11	158531.761182	450949.053911			
13	159854.598769	450960.331378			
15	161177.436355	450971.608846			
17	162496.028748	450985.541583			
19	163801.436000	450999.335000			
31	158533.063580	452261.807771			
33	159853.647897	452273.412932			
35	161174.232213	452285.018093			
37	162490.915468	452297.937933			
39	163786.215375	452310.647950			
51	158534.365979	453574.561632			
53	159852.697025	453586.494486			
55	161171.028070	453598.427340			
57	162485.802212	453610.327999			
59	163770.994750	453621.960901			
71	158535.665048	454889.978005			
73	159851.744390	454900.947357			
75	161167.823732	454911.916709			
77	162482.102887	454922.884050			
79	163758.600198	454933.536110			
91	158536.964117	456205.394378			
93	159850.791755	456215.400228			
95	161164.619394	456225.406078			
97	162478.403579	456235.434190			
99	163746.205646	456245.111320			

START				11	158531.761	450949.054
11	INV N	0-29-18.4 E	2645.771	15	161177.436	450971.609
15	INV N	0-36-19.4 E	2624.146	19	163801.436	450999.335
19	INV S	89-20-06.0 E	2622.803	59	163770.995	453621.961
59	INV S	89-27-30.8 E	2623.268	99	163746.206	456245.111
99	INV S	0-26-14.4 W	2581.661	95	161164.619	456225.406
95	INV S	0-26-10.8 W	2627.731	91	158536.964	456205.394
91	INV S	89-56-36.3 W	2630.834	51	158534.366	453574.562
51	INV S	89-56-35.4 W	2625.509	11	158531.761	450949.054
START				51	158534.366	453574.562
51	INV N	0-31-07.0 E	2636.770	55	161171.028	453598.427
55	INV N	0-31-07.0 E	2600.073	59	163770.995	453621.961
START				15	161177.436	450971.609
15	INV S	89-51-36.8 E	2626.826	55	161171.028	453598.427
55	INV S	89-51-36.8 E	2626.987	95	161164.619	456225.406

POINT-POINT ANGLES								
ANGLE	51 -	11 -	15:	C.W.	270-32-43.0	C.C.W.	89-27-17.0	2645.771
ANGLE	11 -	15 -	19:	C.W.	180-07-01.0	C.C.W.	179-52-59.0	2624.146
ANGLE	15 -	19 -	59:	C.W.	270-03-34.7	C.C.W.	89-56-25.3	2622.803
ANGLE	19 -	59 -	99:	C.W.	179-52-35.1	C.C.W.	180-07-24.9	2623.268
ANGLE	59 -	99 -	95:	C.W.	269-53-45.2	C.C.W.	90-06-14.8	2581.661
ANGLE	99 -	95 -	91:	C.W.	179-59-56.5	C.C.W.	180-00-03.5	2627.731
ANGLE	95 -	91 -	51:	C.W.	269-30-25.5	C.C.W.	90-29-34.5	2630.834
ANGLE	91 -	51 -	11:	C.W.	179-59-59.1	C.C.W.	180-00-00.9	2625.509