

WRIGHT COUNTY SURVEYORS OFFICE

Public Works Building
Buffalo, Minn. 55313

SECTION 30 TOWNSHIP 119 RANGE 24

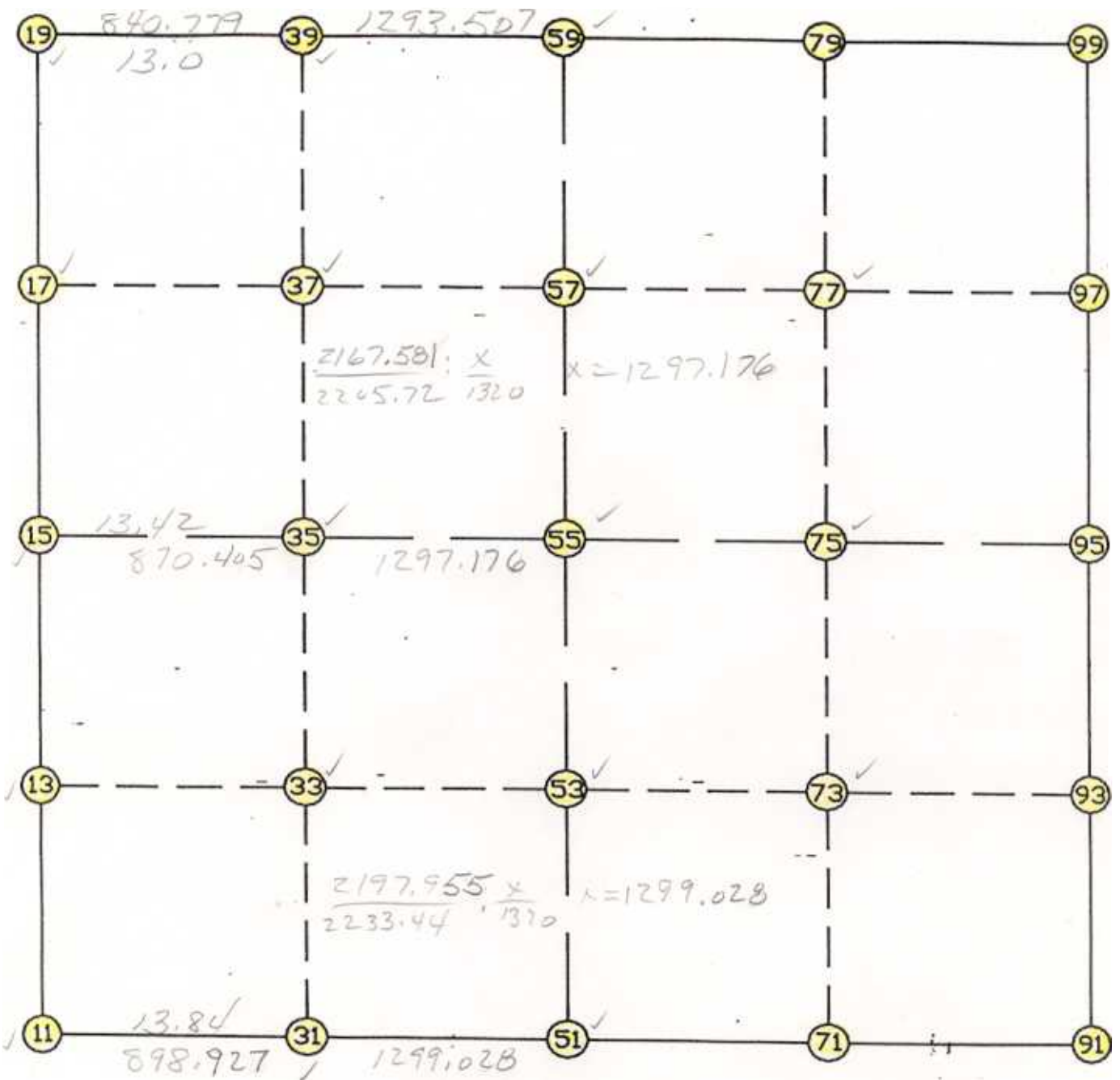

REMARKS

NOTE: WEST LINE OF SECTION 30 ADJUSTED TO EAST LINE OF SECTION 25 T119 R25 THAT WAS ADJUSTED IN STAR FILE "FRANK" (95-57)

THE INFORMATION SHOWN HEREON IS A COMPILATION OF WRIGHT COUNTY RECORDS AND IS INTENDED TO BE USED FOR COMPARISON PURPOSES ONLY. THE COUNTY IS NOT RESPONSIBLE FOR ANY INACCURACIES HEREIN CONTAINED.

LIST POINTS

POINT	NORTHING	EASTING	ELEVATION	DESCR
11	137012.069650	530156.027793		
13	138325.285064	530164.125227		
15	139638.500478	530172.222660		
17	140952.239942	530181.789994		
19	142265.979406	530191.357328		
31	137012.819044	531054.954630		
33	138327.576910	531048.786918		
35	139642.306093	531042.619340		
37	140957.157546	531037.367060		
39	142271.986291	531032.114870		
51	137013.901983	532353.982178		
53	138330.939818	532346.882796		
55	139647.977653	532339.783413		
57	140964.602657	532332.686256		
59	142281.227661	532325.589098		
71	137032.677088	533677.931934		
73	138343.211703	533668.544377		
75	139653.746318	533659.156821		
77	140971.104324	533652.661185		
79	142288.462331	533646.165549		
91	137051.452194	535001.881690		
93	138355.483589	534990.205959		
95	139659.514984	534978.530228		
97	140977.605992	534972.636114		
99	142295.697000	534966.742000		

START				11	137012.070	530156.028
11	INV N	0-21-11.8 E	2626.481	15	139638.500	530172.223
15	INV N	0-25-02.1 E	2627.549	19	142265.979	530191.357
19	INV N	89-35-26.3 E	2134.286	59	142281.228	532325.589
59	INV N	89-41-10.0 E	2641.193	99	142295.697	534966.742
99	INV S	0-15-22.3 E	2636.208	95	139659.515	534978.530
95	INV S	0-30-46.8 E	2608.167	91	137051.452	535001.882
91	INV S	89-11-15.1 W	2648.166	51	137013.902	532353.982
51	INV S	89-57-08.0 W	2197.955	11	137012.070	530156.028
START				51	137013.902	532353.982
51	INV N	0-18-31.8 W	2634.114	55	139647.978	532339.783
55	INV N	0-18-31.8 W	2633.288	59	142281.228	532325.589
START				15	139638.500	530172.223
15	INV N	89-44-58.2 E	2167.581	55	139647.978	532339.783
55	INV N	89-44-58.2 E	2638.772	95	139659.515	534978.530

POINT-POINT ANGLES

ANGLE	51 -	11 -	15:	C. W.	270-24-03.8	C. C. W.	89-35-56.2	2626.481
ANGLE	11 -	15 -	19:	C. W.	180-03-50.3	C. C. W.	179-56-09.7	2627.549
ANGLE	15 -	19 -	59:	C. W.	269-10-24.2	C. C. W.	90-49-35.8	2134.286
ANGLE	19 -	59 -	99:	C. W.	180-05-43.7	C. C. W.	179-54-16.3	2641.193
ANGLE	59 -	99 -	95:	C. W.	270-03-27.6	C. C. W.	89-56-32.4	2636.208
ANGLE	99 -	95 -	91:	C. W.	179-44-35.6	C. C. W.	180-15-24.4	2608.167
ANGLE	95 -	91 -	51:	C. W.	269-42-01.9	C. C. W.	90-17-58.1	2648.166
ANGLE	91 -	51 -	11:	C. W.	180-45-52.9	C. C. W.	179-14-07.1	2197.955

Coordinates stored

Wednesday July 5, 1995

1:40 PM