

WRIGHT COUNTY SURVEYORS OFFICE

Public Works Building  
Buffalo, Minn. 55313

SECTION 19 TOWNSHIP 119 RANGE 24

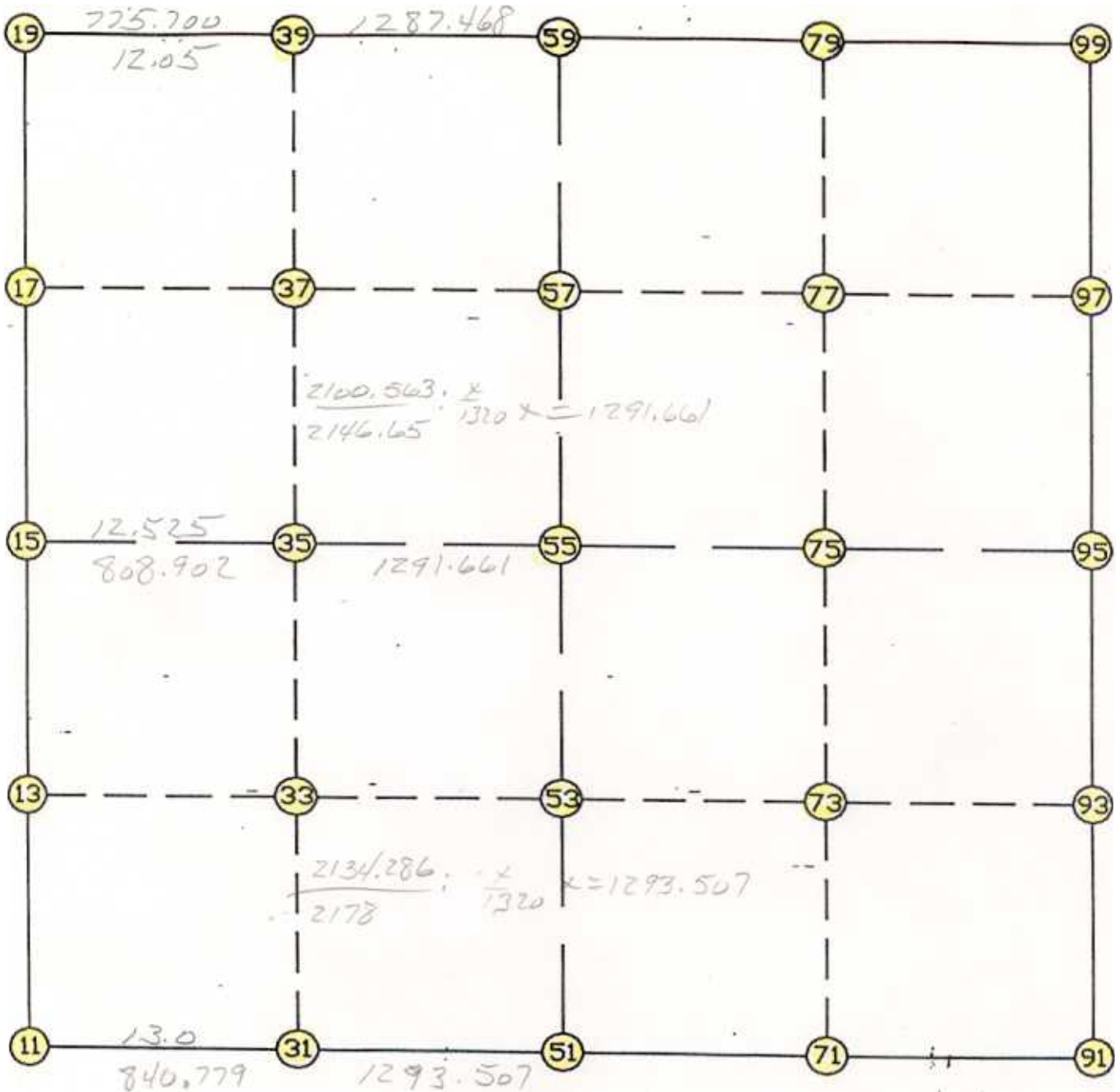

REMARKS

---

---

---

THE INFORMATION SHOWN HEREON IS A COMPILATION OF WRIGHT COUNTY RECORDS AND IS INTENDED TO BE USED FOR COMPARISON PURPOSES ONLY. THE COUNTY IS NOT RESPONSIBLE FOR ANY INACCURACIES HEREIN CONTAINED.

LIST POINTS

POINT	NORTHING	EASTING	ELEVATION	DESCR
11	142265.979406	530191.357328		
13	143581.276133	530200.347052		
15	144896.572860	530209.336777		
17	146210.081430	530220.189888		
19	147523.590000	530231.043000		
31	142271.986293	531032.115111		
33	143588.137390	531025.158592		
35	144904.266312	531018.202190		
37	146219.190728	531012.437065		
39	147534.077118	531006.672106		
51	142281.227661	532325.589098		
53	143598.889468	532317.696881		
55	144916.551275	532309.804664		
57	146234.017194	532301.913621		
59	147551.483114	532294.022577		
71	142288.462331	533646.165549		
73	143608.797394	533639.358153		
75	144929.132457	533632.550756		
77	146246.714489	533622.448743		
79	147564.296521	533612.346730		
91	142295.697000	534966.742000		
93	143618.705320	534961.019424		
95	144941.713639	534955.296848		
96	142295.697000	534966.742000		
97	146259.411783	534942.983865		
99	147577.109927	534930.670883		

START				11	142265.979	530191.357
11	INV N	0-23-29.7 E	2630.655	15	144896.573	530209.337
15	INV N	0-28-24.3 E	2627.107	19	147523.590	530231.043
19	INV N	89-13-31.3 E	2063.168	59	147551.483	532294.023
59	INV N	89-26-35.3 E	2636.773	99	147577.110	534930.671
99	INV S	0-32-07.3 E	2635.511	95	144941.714	534955.297
95	INV S	0-14-52.2 E	2646.041	91	142295.697	534966.742
91	INV S	89-41-10.0 W	2641.193	51	142281.228	532325.589
51	INV S	89-35-26.3 W	2134.286	11	142265.979	530191.357
START				51	142281.228	532325.589
51	INV N	0-20-35.4 W	2635.371	55	144916.551	532309.805
55	INV N	0-20-35.4 W	2634.979	59	147551.483	532294.023
START				15	144896.573	530209.337
15	INV N	89-27-18.2 E	2100.563	55	144916.551	532309.805
55	INV N	89-27-18.2 E	2645.612	95	144941.714	534955.297

POINT-POINT ANGLES

ANGLE	51 -	11 -	15:	C.W.	270-48-03.4	C.C.W.	89-11-56.6	2630.655
ANGLE	11 -	15 -	19:	C.W.	180-04-54.5	C.C.W.	179-55-05.5	2627.107
ANGLE	15 -	19 -	59:	C.W.	268-45-07.0	C.C.W.	91-14-53.0	2063.168
ANGLE	19 -	59 -	99:	C.W.	180-13-04.0	C.C.W.	179-46-56.0	2636.773
ANGLE	59 -	99 -	95:	C.W.	270-01-17.4	C.C.W.	89-58-42.6	2635.511
ANGLE	99 -	95 -	91:	C.W.	180-17-15.2	C.C.W.	179-42-44.8	2646.041
ANGLE	95 -	91 -	51:	C.W.	269-56-02.2	C.C.W.	90-03-57.8	2641.193
ANGLE	91 -	51 -	11:	C.W.	179-54-16.3	C.C.W.	180-05-43.7	2134.286

Coordinates stored

Friday May 5, 1995

12:30 PM