

WRIGHT COUNTY SURVEYORS OFFICE

Public Works Building
Buffalo, Minn. 55313

SECTION 7 TOWNSHIP 119 RANGE 24

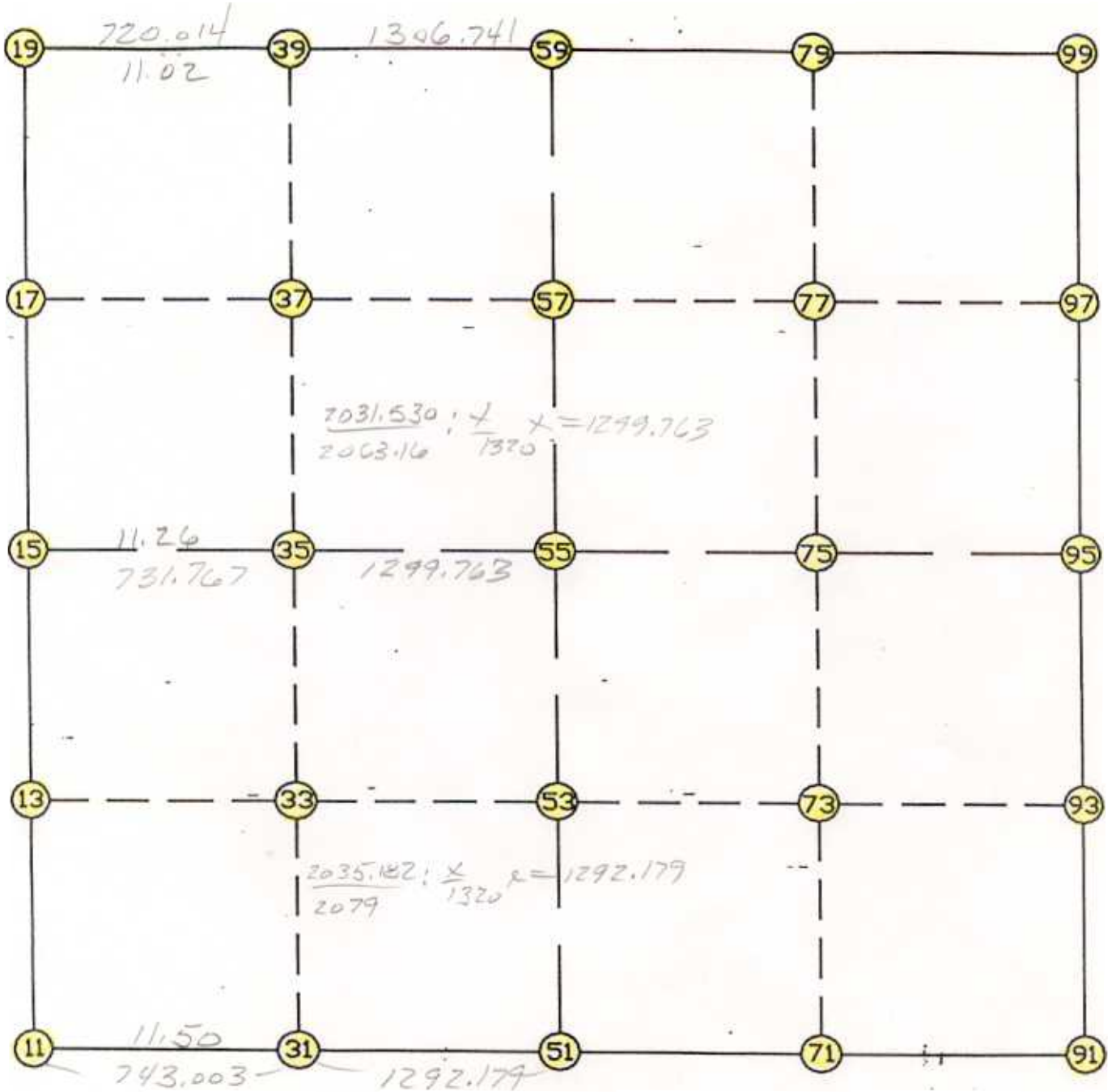

REMARKS

THE INFORMATION SHOWN HEREON IS A COMPILATION OF WRIGHT COUNTY RECORDS AND IS INTENDED TO BE USED FOR COMPARISON PURPOSES ONLY. THE COUNTY IS NOT RESPONSIBLE FOR ANY INACCURACIES HEREIN CONTAINED.

COGO =====

Friday May 5, 1995

9:35 AM

Coordinate File Name: SEC-07.CRD Lowest pt #: 1 Highest pt #: 99
 Job # : 95-16
 Description: COUNTY COORDINTES SECTION 7 T119 R24
 # of chars. in point descr.: 10

 FROM TYPE BEARING DISTANCE TO NORTHING EASTING

LIST POINTS

POINT	NORTHING	EASTING	ELEVATION	DESCR
11	152800.842314	530257.202696		
13	154112.089244	530267.146610		
15	155423.336174	530277.090524		
17	156737.803102	530287.627788		
19	158052.270029	530298.165052		
31	152811.027055	531000.135641		
33	154123.163878	531004.447802		
35	155435.287689	531008.759919		
37	156750.688155	531013.403340		
39	158066.074352	531018.046710		
51	152828.739653	532292.193238		
53	154142.627796	532300.271311		
55	155456.515940	532308.349385		
57	156773.821761	532316.448471		
59	158091.127581	532324.547557		
71	152846.937224	533613.658412		
73	154162.455918	533617.851788		
75	155477.974612	533622.045165		
77	156795.225829	533627.139886		
79	158112.477045	533632.234608		
91	152865.134794	534935.123587		
93	154182.284039	534935.432266		
95	155499.433284	534935.740945		
97	156816.629897	534937.831302		
99	158133.826509	534939.921659		

START			11	152800.842	530257.203
11	INV N	0-26-04.2 E	2622.569	15	155423.336
15	INV N	0-27-33.5 E	2629.018	19	158052.270
19	INV N	88-54-05.2 E	2026.755	59	158091.128
59	INV N	89-03-52.8 E	2615.723	99	158133.827
99	INV S	0-05-27.3 W	2634.397	95	155499.433
95	INV S	0-00-48.3 W	2634.299	91	152865.135
91	INV S	89-12-39.8 W	2643.181	51	152828.740
51	INV S	89-12-52.5 W	2035.182	11	152800.842
START			51	152828.740	532292.193
51	INV N	0-21-08.1 E	2627.826	55	155456.516
55	INV N	0-21-08.1 E	2634.661	59	158091.128
START			15	155423.336	530277.091
15	INV N	89-03-51.1 E	2031.530	55	155456.516
55	INV N	89-03-51.1 E	2627.742	95	155499.433

POINT-POINT ANGLES

ANGLE	51 -	11 -	15:	C.W.	271-13-11.7	C.C.W.	88-46-48.3	2622.569
ANGLE	11 -	15 -	19:	C.W.	180-01-29.3	C.C.W.	179-58-30.7	2629.018
ANGLE	15 -	19 -	59:	C.W.	268-26-31.7	C.C.W.	91-33-28.3	2026.755
ANGLE	19 -	59 -	99:	C.W.	180-09-47.6	C.C.W.	179-50-12.4	2615.723
ANGLE	59 -	99 -	95:	C.W.	271-01-34.5	C.C.W.	88-58-25.5	2634.397
ANGLE	99 -	95 -	91:	C.W.	179-55-21.0	C.C.W.	180-04-39.0	2634.299
ANGLE	95 -	91 -	51:	C.W.	269-11-51.4	C.C.W.	90-48-08.6	2643.181
ANGLE	91 -	51 -	11:	C.W.	180-00-12.8	C.C.W.	179-59-47.2	2035.182

Coordinates stored

Friday May 5, 1995

9:36 AM