

WRIGHT COUNTY SURVEYORS OFFICE
Public Works Building
Buffalo, Minn. 55815

SECTION: 21 TOWNSHIP 118 RANGE 28

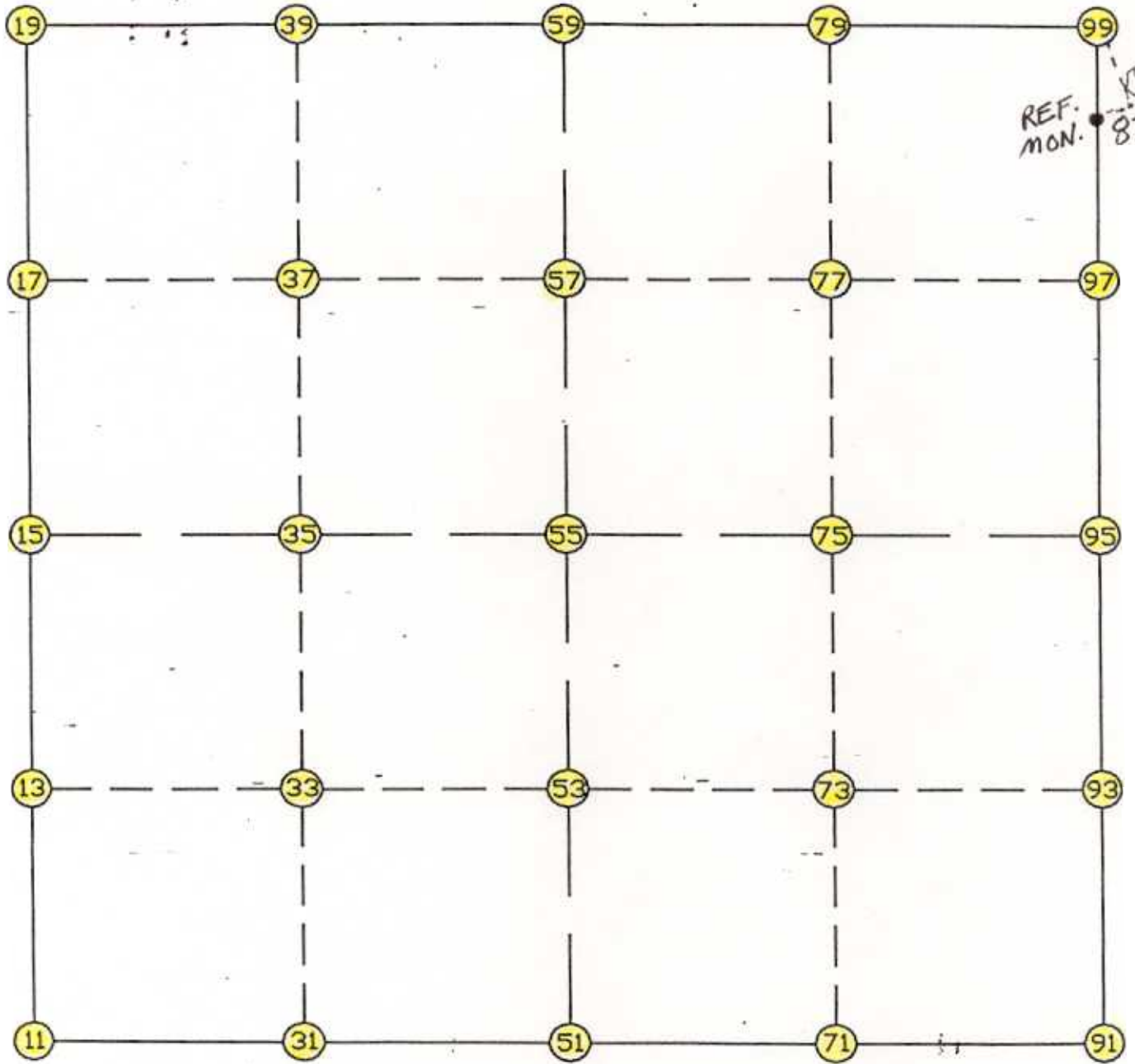

REMARKS

THE INFORMATION SHOWN HEREON IS A COMPILATION OF WRIGHT COUNTY RECORDS AND IS INTENDED TO BE USED FOR COMPARISON PURPOSES ONLY. THE COUNTY IS NOT RESPONSIBLE FOR ANY INACCURACIES HEREIN CONTAINED.

point(s) 1 through 5 deleted.

Coordinates stored Monday November 14, 1994 1:46 PM

COGO ===== Monday November 14, 1994 1:46 PM

Coordinate File Name: SEC-21.CRD Lowest pt #: 1 Highest pt #: 100
Job # : 93-02
Description: COUNTY COORDINATES SECTION 21-118-28
of chars. in point descr.: 10

FROM TYPE BEARING DISTANCE TO NORTHING EASTING

LIST POINTS

POINT	NORTHING	EASTING	ELEVATION	DESCR
11	111268.301	413703.894		SW COR
13	112589.311	413699.600		
15	113910.320	413695.306		W1/4
17	115231.378	413711.499		
19	116552.436	413727.691		NW COR
31	111261.328	415012.265		
33	112564.096	415014.927		
35	113866.863	415017.589		
37	115201.089	415030.730		
39	116535.316	415043.872		
51	111254.356	416320.636		S1/4
53	112538.880	416330.255		
55	113823.405	416339.873		
57	115170.801	416349.962		
59	116518.196	416360.052		N1/4
71	111176.075	417559.630		
73	112479.476	417566.305		
75	113782.878	417572.980		
77	115112.448	417587.154		
79	116442.018	417601.329		
91	111097.793	418798.624		SE COR
93	112420.072	418802.355		
95	113742.351	418806.087		E1/4
97	115054.096	418824.347		
99	116365.840	418842.606		NE COR

START					11	111268.301	413703.894	SW COR
11	INV N	0-11-10.5	W	2642.034	15	113910.320	413695.306	W1/4
15	INV N	0-42-08.2	E	2642.314	19	116552.436	413727.691	NW COR
19	INV S	89-15-17.3	E	2632.583	59	116518.196	416360.052	N1/4
59	INV S	86-29-17.2	E	2487.225	99	116365.840	418842.606	NE COR
99	INV S	0-47-51.0	W	2623.743	95	113742.351	418806.087	E1/4
95	INV S	0-09-42.1	W	2644.568	91	111097.793	418798.624	SE COR
91	INV N	86-23-05.2	W	2482.929	51	111254.356	416320.636	S1/4
51	INV N	89-41-40.8	W	2616.779	11	111268.301	413703.894	SW COR

START					51	111254.356	416320.636	S1/4
51	INV N	0-25-44.5	E	2569.121	55	113823.405	416339.873	
55	INV N	0-25-44.5	E	2694.867	59	116518.196	416360.052	N1/4
START					15	113910.320	413695.306	W1/4
15	INV S	88-07-03.4	E	2645.995	55	113823.405	416339.873	
55	INV S	88-07-03.4	E	2467.546	95	113742.351	418806.087	E1/4

POINT-POINT ANGLES

ANGLE	51 -	11 -	15:	C.W.	269-30-30.3	C.C.W.	90-29-29.7	2642.034
ANGLE	11 -	15 -	19:	C.W.	180-53-18.7	C.C.W.	179-06-41.3	2642.314
ANGLE	15 -	19 -	59:	C.W.	270-02-34.6	C.C.W.	89-57-25.4	2632.583
ANGLE	19 -	59 -	99:	C.W.	182-46-00.0	C.C.W.	177-14-00.0	2487.225
ANGLE	59 -	99 -	95:	C.W.	267-17-08.3	C.C.W.	92-42-51.7	2623.743
ANGLE	99 -	95 -	91:	C.W.	179-21-51.1	C.C.W.	180-38-08.9	2644.568
ANGLE	95 -	91 -	51:	C.W.	273-27-12.7	C.C.W.	86-32-47.3	2482.929
ANGLE	91 -	51 -	11:	C.W.	176-41-24.4	C.C.W.	183-18-35.6	2616.779

Coordinates stored

Monday November 14, 1994

1:48 PM