

WRIGHT COUNTY SURVEYORS OFFICE

Public Works Building  
Buffalo, Minn. 56313

SECTION 3 TOWNSHIP 118 RANGE 28

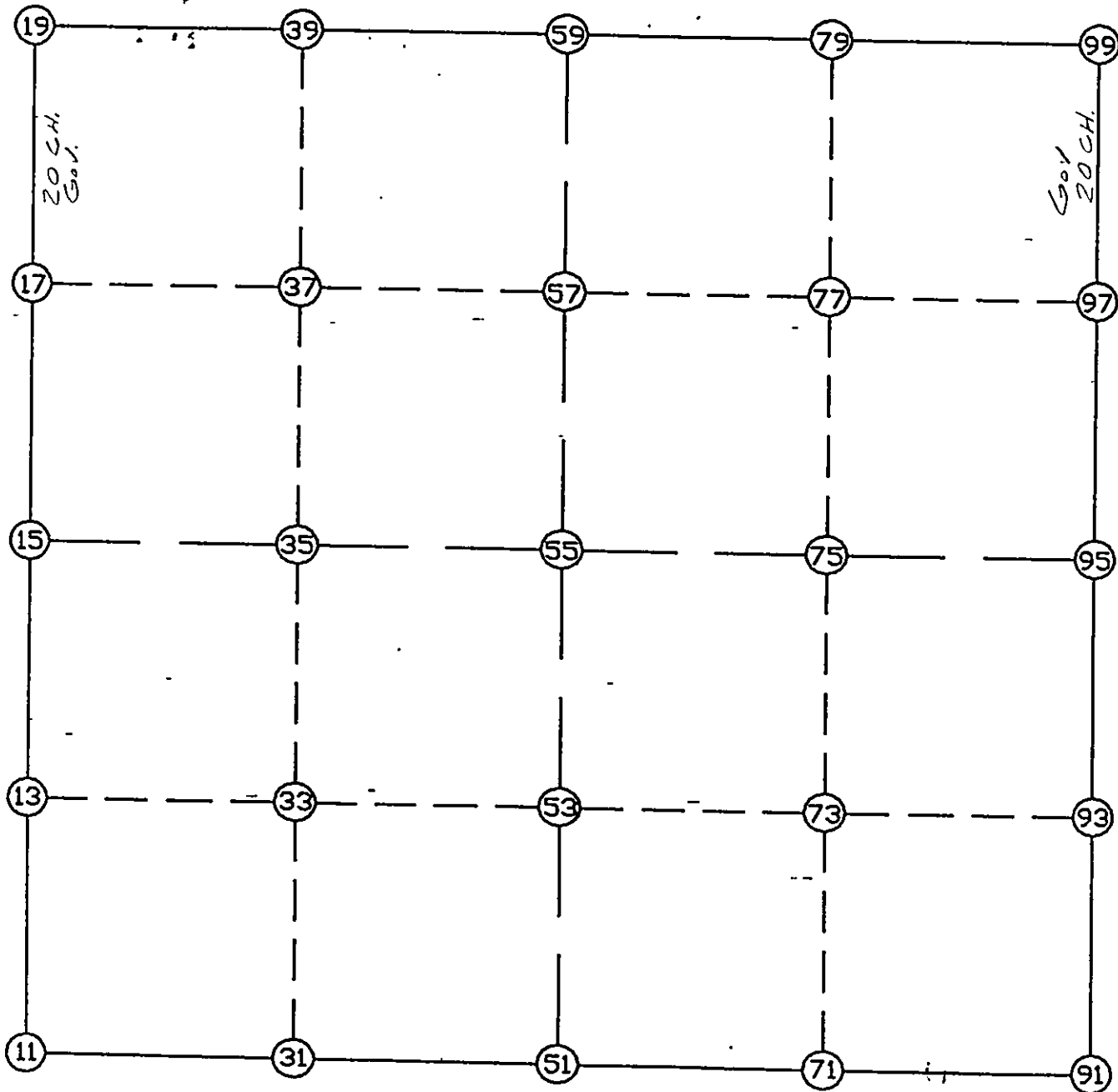

REMARKS

\_\_\_\_\_  
\_\_\_\_\_  
\_\_\_\_\_

THE INFORMATION SHOWN HEREON IS A COMPILATION OF WRIGHT COUNTY RECORDS AND IS INTENDED TO BE USED FOR COMPARISON PURPOSES ONLY. THE COUNTY IS NOT RESPONSIBLE FOR ANY INACCURACIES HEREIN CONTAINED.

## LIST POINTS

POINT	NORTHING	EASTING	ELEVATION	DESCR
11	127007.222	419209.245		SW COR
13	128324.678	419244.596		
15	129642.134	419279.947		W1/4
17	130952.882	419313.419		
19	132263.630	419346.890		NW COR
31	126987.769	420610.046		
33	128298.142	420624.056		
35	129608.515	420638.066		
37	130920.155	420651.111		
39	132231.795	420664.155		
51	126968.317	422010.846		S1/4
53	128271.607	422003.516		
55	129574.897	421996.185		CENTER
57	130887.428	421988.803		
59	132199.960	421981.420		N1/4
71	126933.031	423395.928		
73	128237.235	423371.889		
75	129541.439	423347.850		
77	130858.749	423323.443		
79	132176.059	423299.035		
91	126897.746	424781.009		SE COR
93	128202.863	424740.262		
95	129507.980	424699.515		E1/4
97	130830.069	424658.083		
99	132152.158	424616.651		NE COR

START				11	127007.222	419209.245	SW COR
11	INV N	1-32-13.3 E	2635.860	15	129642.134	419279.947	W1/4
15	INV N	1-27-46.1 E	2622.350	19	132263.630	419346.890	NW COR
19	INV S	88-36-56.1 E	2635.299	59	132199.960	421981.420	N1/4
59	INV S	88-57-38.9 E	2635.664	99	132152.158	424616.651	NE COR
99	INV S	1-47-41.9 E	2645.476	95	129507.980	424699.515	E1/4
95	INV S	1-47-17.7 E	2611.506	91	126897.746	424781.009	SE COR
91	INV N	88-32-26.5 W	2771.061	51	126968.317	422010.846	S1/4
51	INV N	89-12-15.8 W	2801.871	11	127007.222	419209.245	SW COR

START				51	126968.317	422010.846	S1/4
51	INV N	0-19-20.2 W	2606.622	55	129574.897	421996.185	CENTER
55	INV N	0-19-20.2 W	2625.104	59	132199.960	421981.420	N1/4
59	INV S	46-33-52.3 W	3720.273	15	129642.134	419279.947	W1/4
START				15	129642.134	419279.947	W1/4
15	INV S	88-34-55.2 E	2717.070	55	129574.897	421996.185	CENTER
55	INV S	88-34-55.2 E	2704.158	95	129507.980	424699.515	E1/4

## POINT-POINT ANGLES

ANGLE	51 -	11 -	15:	C. W.	270-44-29.2	C. C. W.	89-15-30.8	2635.860
ANGLE	11 -	15 -	19:	C. W.	179-55-32.8	C. C. W.	180-04-27.2	2622.350
ANGLE	15 -	19 -	59:	C. W.	269-55-17.8	C. C. W.	90-04-42.2	2635.299
ANGLE	19 -	59 -	99:	C. W.	179-39-17.2	C. C. W.	180-20-42.8	2635.664
ANGLE	59 -	99 -	95:	C. W.	267-09-57.0	C. C. W.	92-50-03.0	2645.476
ANGLE	99 -	95 -	91:	C. W.	180-00-24.2	C. C. W.	179-59-35.8	2611.506
ANGLE	95 -	91 -	51:	C. W.	273-14-51.2	C. C. W.	86-45-08.8	2771.061
ANGLE	91 -	51 -	11:	C. W.	179-20-10.7	C. C. W.	180-39-49.3	2801.871