

WRIGHT COUNTY SURVEYORS OFFICE

Public Works Building  
Buffalo, Minn. 55313

SECTION 30 TOWNSHIP 118 RANGE 25

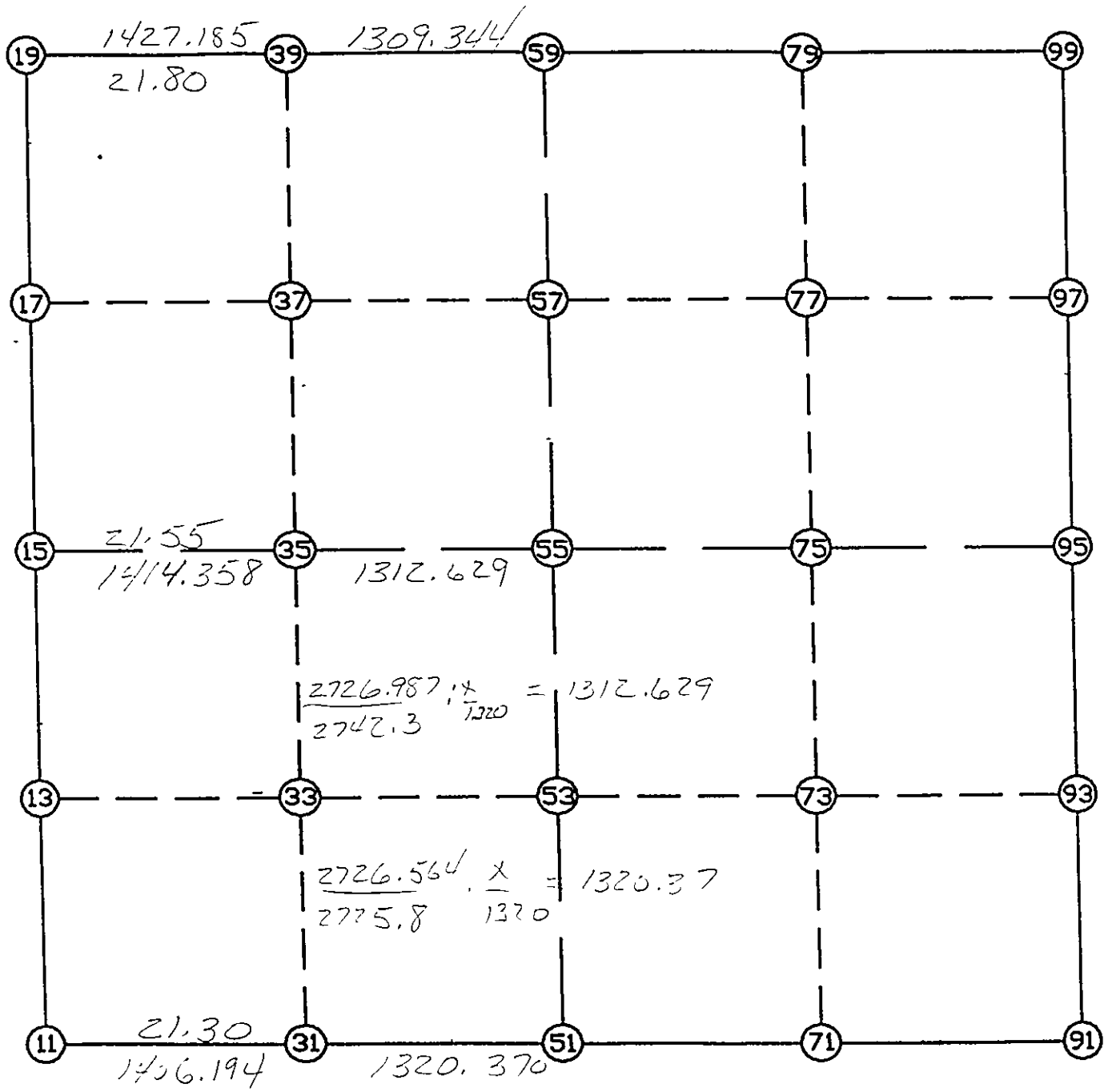

REMARKS

---

---

---

THE INFORMATION SHOWN HEREON IS A COMPILATION OF WRIGHT COUNTY RECORDS AND IS INTENDED TO BE USED FOR COMPARISON PURPOSES ONLY. THE COUNTY IS NOT RESPONSIBLE FOR ANY INACCURACIES HEREIN CONTAINED.

Coordinate File Name: SEC-30.CRD    Lowest pt #:    1    Highest pt #:    99  
 Job #            : 95-57  
 Description: COUNTY COORDINATES SECTION 30 T118 R25  
 # of chars. in point descr.: 10

-----  
 FROM TYPE            BEARING    DISTANCE    TO            NORTHING        EASTING  
 -----

LIST POINTS

POINT	NORTHING	EASTING	ELEVATION	DESCR
11	105503.335464	498293.929143		
13	106813.748925	498298.078388		
15	108124.162385	498302.227633		
17	109437.914969	498301.675724		
19	110751.667552	498301.123815		
31	105473.506885	499699.806846		
33	106809.623295	499708.112376		
35	108145.884986	499716.418809		
37	109455.233763	499722.334762		
39	110764.557657	499728.250603		
51	105445.498831	501019.879755		
53	106805.771998	501024.386291		
55	108166.045165	501028.892827		
57	109471.214302	501033.216806		
59	110776.383438	501037.540784		
71	105436.481387	502333.413422		
73	106810.642036	502291.731926		
75	108184.802685	502250.050430		
77	109492.131475	502300.686349		
79	110799.460265	502351.322268		
91	105427.463943	503646.947088		
93	106815.512074	503559.077560		
95	108203.560204	503471.208032		
97	109513.048648	503568.155892		
99	110822.537092	503665.103752		

START			11	105503.335	498293.929
11	INV N	0-10-53.1 E	2620.840	15	108124.162
15	INV N	0-01-26.7 W	2627.505	19	110751.668
19	INV N	89-28-57.0 E	2736.529	59	110776.383
59	INV N	88-59-37.3 E	2627.968	99	110822.537
99	INV S	4-14-03.0 W	2626.145	95	108203.560
95	INV S	3-37-20.1 E	2781.653	91	105427.464
91	INV N	89-36-24.0 W	2627.129	51	105445.499
51	INV N	88-47-04.3 W	2726.564	11	105503.335

START			51	105445.499	501019.880
51	INV N	0-11-23.3 E	2720.561	55	108166.045
55	INV N	0-11-23.3 E	2610.353	59	110776.383

START			15	108124.162	498302.228
15	INV N	89-07-11.9 E	2726.987	55	108166.045
55	INV N	89-07-11.9 E	2442.603	95	108203.560

POINT-POINT ANGLES

ANGLE	51 -	11 -	15:	C.W.	268-57-57.4	C.C.W.	91-02-02.6	2620.840
ANGLE	11 -	15 -	19:	C.W.	179-47-40.2	C.C.W.	180-12-19.8	2627.505
ANGLE	15 -	19 -	59:	C.W.	269-30-23.7	C.C.W.	90-29-36.3	2736.529
ANGLE	19 -	59 -	99:	C.W.	179-30-40.3	C.C.W.	180-29-19.7	2627.968
ANGLE	59 -	99 -	95:	C.W.	275-14-25.7	C.C.W.	84-45-34.3	2626.145
ANGLE	99 -	95 -	91:	C.W.	172-08-36.9	C.C.W.	187-51-23.1	2781.653
ANGLE	95 -	91 -	51:	C.W.	274-00-56.1	C.C.W.	85-59-03.9	2627.129
ANGLE	91 -	51 -	11:	C.W.	180-49-19.7	C.C.W.	179-10-40.3	2726.564