

WRIGHT COUNTY SURVEYORS OFFICE

Public Works Building
Buffalo, Minn. 55313

SECTION 8 TOWNSHIP 118 RANGE 25

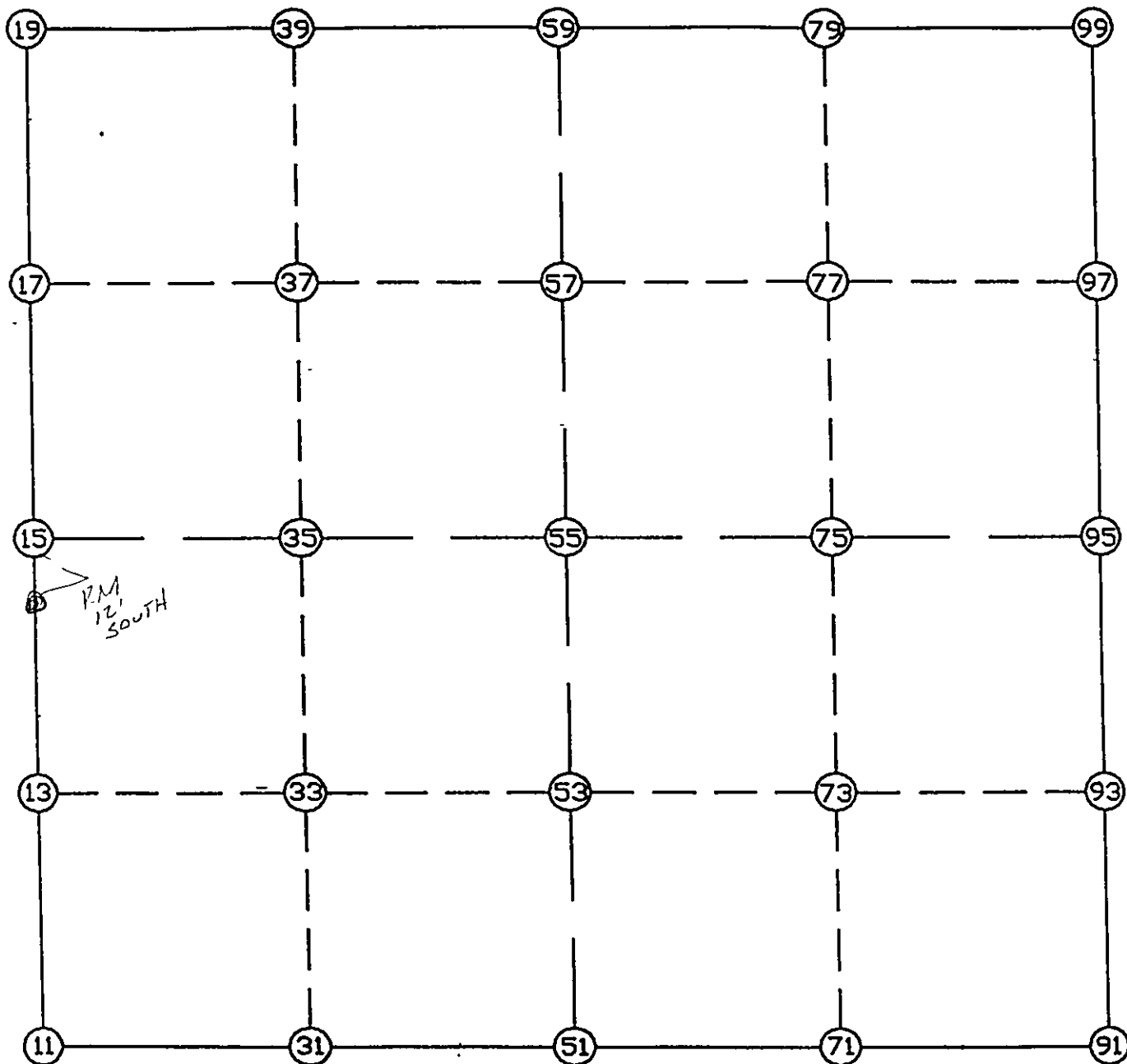

REMARKS

THE INFORMATION SHOWN HEREON IS A COMPILATION OF WRIGHT COUNTY RECORDS AND IS INTENDED TO BE USED FOR COMPARISON PURPOSES ONLY. THE COUNTY IS NOT RESPONSIBLE FOR ANY INACCURACIES HEREIN CONTAINED.

Coordinate File Name: SEC-08.CRD Lowest pt #: 1 Highest pt #: 99

Job # : 95-57

Description: COUNTY COORDINATES SECTION 8 T118 R25

of chars. in point descr.: 10

FROM TYPE	BEARING	DISTANCE	TO	NORTHING	EASTING
-----------	---------	----------	----	----------	---------

LIST POINTS

POINT	NORTHING	EASTING	ELEVATION	DESCR
11	121258.663754	503849.612525		
13	122593.866734	503752.486743		
15	123929.069715	503655.360961		
17	125263.655454	503551.196120		
19	126598.241193	503447.031278		
31	121256.584763	505167.493371		
33	122586.652355	505099.760854		
35	123916.719948	505032.028337		
37	125245.501365	504960.804577		
39	126574.282782	504889.580817		
51	121254.505772	506485.374218		
53	122579.437976	506447.034965		
55	123904.370180	506408.695713		
57	125227.347275	506370.413034		
59	126550.324370	506332.130356		
71	121250.743340	507803.247188		
73	122571.339605	507799.017212		
75	123891.935871	507794.787236		
77	125209.183072	507780.400529		
79	126526.430273	507766.013823		
91	121246.980907	509121.120159		
93	122563.241235	509150.999459		
95	123879.501562	509180.878760		
97	125191.018869	509190.388024		
99	126502.536176	509199.897289		

START				11	121258.664	503849.613
11	INV N	4-09-37.8 W	2677.462	15	123929.070	503655.361
15	INV N	4-27-46.5 W	2677.289	19	126598.241	503447.031
19	INV S	89-02-54.6 E	2885.497	59	126550.324	506332.130
59	INV S	89-02-43.1 E	2868.165	99	126502.536	509199.897
99	INV S	0-24-55.5 W	2623.104	95	123879.502	509180.879
95	INV S	1-18-01.4 W	2633.199	91	121246.981	509121.120
91	INV N	89-50-11.1 W	2635.757	51	121254.506	506485.374
51	INV N	89-54-34.6 W	2635.765	11	121258.664	503849.613

START				51	121254.506	506485.374
51	INV N	1-39-27.0 W	2650.974	55	123904.370	506408.696
55	INV N	1-39-27.0 W	2647.062	59	126550.324	506332.130

START				15	123929.070	503655.361
15	INV S	89-29-09.7 E	2753.446	55	123904.370	506408.696
55	INV S	89-29-09.7 E	2772.295	95	123879.502	509180.879

POINT-POINT ANGLES

ANGLE	51 -	11 -	15:	C.W.	265-44-56.8	C.C.W.	94-15-03.2	2677.462
ANGLE	11 -	15 -	19:	C.W.	179-41-51.3	C.C.W.	180-18-08.7	2677.289
ANGLE	15 -	19 -	59:	C.W.	275-24-51.9	C.C.W.	84-35-08.1	2885.497
ANGLE	19 -	59 -	99:	C.W.	180-00-11.4	C.C.W.	179-59-48.6	2868.165
ANGLE	59 -	99 -	95:	C.W.	269-27-38.7	C.C.W.	90-32-21.3	2623.104
ANGLE	99 -	95 -	91:	C.W.	180-53-05.9	C.C.W.	179-06-54.1	2633.199
ANGLE	95 -	91 -	51:	C.W.	268-51-47.4	C.C.W.	91-08-12.6	2635.757
ANGLE	91 -	51 -	11:	C.W.	179-55-36.5	C.C.W.	180-04-23.5	2635.765